



The World's Best Massage Chairs

Escape Massage Chair User's Manual

*Make your life healthy
and beautiful every day!*



The World's Best Massage Chairs

Please read SAFETY INSTRUCTIONS carefully before using the chair.

INFINITY

Escape Massage Chair

Function Introduction

1. Using different massage techniques like kneading, tapping, pressing, knocking and shiatsu, the Escape massage chair can provide a very comfortable massage on neck and back. Enjoy the feeling of a real human hands massaging you into levels of relaxation you have never felt before!
2. With back scan technology, the Escape can supply a custom massage to different people with different body height and shape.
3. Super long L-shaped track gives you an intimate massage from head to bottom, achieving rapid alleviation of pressure to the spine.
4. One-button press to perform zero gravity lie down function. It can effectively alleviate the pressure on spine and joints, allowing you to experience the real zero gravity.
5. The forward sliding function of 4 inches from the wall. The backrest and seat frame move together and take full advantage of available space.
6. The foot parts with full scrapping function, with rollers in feet, combine with gentle air bag force to stimulate the soles.
7. Leg parts equipped with multiple airbags, perform pulse air pressure massage on legs, to promote blood circulation, and restore vitality.
8. Air pressure squeezing massage on your arms, which can promote blood circulation
9. The seat comes with gentle squeezing massage powered by air bags, relaxing the muscles and providing relaxation.
10. The legrest and foot parts can be adjusted to almost any angle. The footrest can be extended and contracted approx 6" so almost anyone can fit in the chair.
11. Ergonomic and beautiful high resolution TFT big screen controller shows massage parts, methods, and status all at the same time.

- ★ 1 Thank you for choosing this INFINITY Escape Massage chair.
- 2. Please read this manual carefully before using the massage chair.
- 3. Please keep this manual in a safe place for further reference.
- 4. Please pay attention to SAFETY INSTRUCTIONS.



★ Note: We reserve the right for design modification. It is subject to change without notice. The pictures in this manual are only for reference. Please refer to the actual product.

Content





Preparation	Safety instructions 1
	External structure parts 5
	Internal structure parts 6
	Mechanical components diagram 7
	Mechanical components list 8
Installation	Installation 9
Massage Operation	The adjustment before massage 13
	Manual control 15
	Operation instruction & function illustration 19
	After massage 21
Maintenance	Cleaning and Maintenance 22
Others	Malfunction guide 23
	Technical data 24

Please keep this manual in a safe place for future reference.

- ★ Please read this manual carefully to make sure the installation and operation of the massage chair is correct.
- ★ “Safety Instructions” is provided in both Warning and Caution for important safety information.

 Warning	This sign indicates warning of causing personal injury.
 Caution	This sign indicates possibility of damage to the chair.



Symbol meaning



	This sign indicates forbidden behavior.		This sign indicates self disassembly is forbidden.
	This sign indicates must follow instruction to operate.		This sign indicates correct operation of cable.





- ★ The following should be kept for any further references.



Warning

	<ul style="list-style-type: none"> ● Osteoporosis patient; ● People with heart disease including embedded pacemaker or other medical electronic device inside the body; ● For pregnant women or people not healthy, please consult doctor before use; ● Patients with a high fever forbid to use this machine. ● Perceptual disabilities patients forbid to use this machine. ● Children should not use this chair. ● Do not use this chair when intoxicated. 	People who are not suitable to use the chair
	<ul style="list-style-type: none"> ● Make sure there are no kids or pets or other objects around (under, behind or in front of) the chair at the moment of backrest, leg-rest up/down or leg-rest retraction/extension from reclining position. ● If you feel ill while using chair, consult a physician as soon as possible. ● Please do not take strong massage on the head. ● Do not massage belly or knees, be careful when massage neck. ● Children or pets are not allowed to play on the chair especially during massage. Standing or sitting on the back or armrest is not allowed either. ● Those who move around difficultly or can't express themselves must be taken care of strictly and continuously during massage. 	Accident/injury
	<ul style="list-style-type: none"> ● Insert the plug of the chair into correct and suitable power socket. Make sure the plug is completely inserted into the socket to reduce short circuit or fire risk. ● Unplug the power when not in use, stop all massage functions and turn off on/off key before unplugging. 	Fire and electric shock
	<ul style="list-style-type: none"> ● It is prohibited to use the massage chair while any items covered the massage chair ventilation holes. ● Massage cushions of the chair are not allowed to fold for storage. ● The machine is forbidden for no-load running for a long time. 	Accident
	<ul style="list-style-type: none"> ● Power cord, plug, socket can't be used in broken or loose contact condition. ● Don't use other electric power except rated voltage in case of fire, electric shock or any breakdown. ● Any broken, re-process, knotted, twisted power cord or pressed under heavy cargo is not allowed to use. 	Fire and electric shock
	<ul style="list-style-type: none"> ● If the chair works dysfunctional, or is broken, splashed with water or falls into water, please have it repaired by professional repairman or send the chair to assigned service agent. ● If power cord or plug is damaged, please don't replace it yourself, please contact us or appointed dealer for replacement. ● To avoid electric shock or body hurt, please don't open or disassemble any part of the chair, there is not any attached part of the chair for maintenance by customers. ● Check leather or cloth material on the back and other areas is broken or not. If broken, even though it is small, please stop using the chair, unplug the power and have it repaired 	Disassembly and maintenance

 Caution		
	<ul style="list-style-type: none"> ● Please operate the chair in a flat or level place 	To avoid sudden falling.
	<ul style="list-style-type: none"> ● Position the chair 4" from the wall to allow for sufficient space to recline up and down. 	To make the back able to recline
	<ul style="list-style-type: none"> ● The maximum suggested operating time is 20mins. 5mins for each position beginning with the slight- step massage. Along continuous massage in the same position may cause uncomfortable feeling. 	Too long time massage is bad for your body.
	<ul style="list-style-type: none"> ● Before sitting on the chair to avoid injury please inspect everything to confirm that the massage heads are in the correct position. 	To avoid accidental injury.
	<ul style="list-style-type: none"> ● Please make sure that the power switch is at the "OFF" position before inserting the plug into the socket. 	To avoid the accident when turn on the power.
	<ul style="list-style-type: none"> ● Turn off all controls before removing plug from outlet. 	To reduce short circuits and any fire hazard.
	<ul style="list-style-type: none"> ● Make sure the plug completely insert into the socket. 	To avoid electric shock in any leakage or breakdown.
	<ul style="list-style-type: none"> ● Check for damage to power cord. Make sure there is no water on cord or and damage. ● Make sure the cord used for the chair and the outlet both have working earth ground. 	
	<ul style="list-style-type: none"> ● Don't press with hands or step on the massage heads with feet. ● Don't put hands between the working massage heads. ● Don't put hands or feet in the gap of mechanical parts. ● Don't drop or embed anything into the slot of massage chair. ● Don't stand or sit or put anything on the backrest, armrest or leg-rest. ● Don't stand on the chair during operation. ● Don't move the chair during operation. ● Don't pull out the plug or turn off the power during operation. ● Don't put your hands or head between leg-rest or beneath. ● Don't use the massage chair while wearing hair ornaments. ● Make sure pockets are empty when massaging. 	To avoid accidents or injury
	<ul style="list-style-type: none"> ● Don't sit or press on the backrest when the chair is in reclining position. ● Don't use bare skin or wear thin clothing, as this can cause irritation to the skin. 	
	<ul style="list-style-type: none"> ● Keep the chair away from heat, wet, sharp things and corrosive, inflammable, explosive environment. ● To use electric blanket or other heating products on the chair is forbidden. ● Keep chair away from excess dust and dirt. 	To avoid fading and discoloration on upholstery and vinyl.
	<ul style="list-style-type: none"> ● Use the chair in places that have good air circulation only. 	
	<ul style="list-style-type: none"> ● Keep the chair away from stove or other heating products. ● Don't put the chair directly under the sun or other high temperature places. 	
	<ul style="list-style-type: none"> ● Do not use the chair outdoors. 	

 Caution		
	<ul style="list-style-type: none"> ● Don't use or store the chair in the wet environment like nearing the swimming pool, or bathroom. ● Keep the chair and remote control dry all the time. ● Don't use the chair when your body is wet. 	To avoid leakage or electric shock.
	<ul style="list-style-type: none"> ● Make sure to install the ground wire in the correct way. An ungrounded chair may cause electric shock. If you are not sure about your grounding, please consult an electrician. ● Do not use any plug adaptors with this massage chair. If the plug does not match your socket please consult an electrician to install a matched socket. 	To avoid electric shock.
	<ul style="list-style-type: none"> ● Unplug the power before cleaning the chair. ● Unplug the power after using the chair. 	To avoid electric shock or fire hazard.
	<ul style="list-style-type: none"> ● Unplug the chair if you notice any damage to power. ● Hold the plug to unplug the power but not try to pull the wire to unplug the power. 	
	<ul style="list-style-type: none"> ● Please turn off the power switch and unplug the power after massage. 	To avoid accidents
	<ul style="list-style-type: none"> ● Unplug the power immediately when electricity goes off. 	To avoid damage or accidents when power on again.

Grounding instruction

- ✧ ※The chair is equipped with a cord having an grounding conductor. The plug must be plugged into an appropriate socket that is properly installed and matched with the plug.

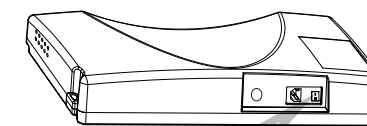
**Replace fuse**

- ✧ When the fuse is burned out, please turn off the power switch and unplug the power. Open the lid over the fuse which is located in the switch box. Replace the fuse with a good fuse of the same size and specs, then close the cover and test chair. If you are not able to do this, find an electrician to replace the fuse.

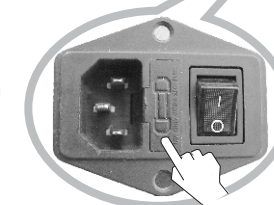

Earth wire is not allowed to be in these places

Gas Pipe: Could cause fire.
 Phone wire and lightning rod: Could cause fire or electric shock.
 Water Pipe: Plastics will not provide correct ground.

External structure

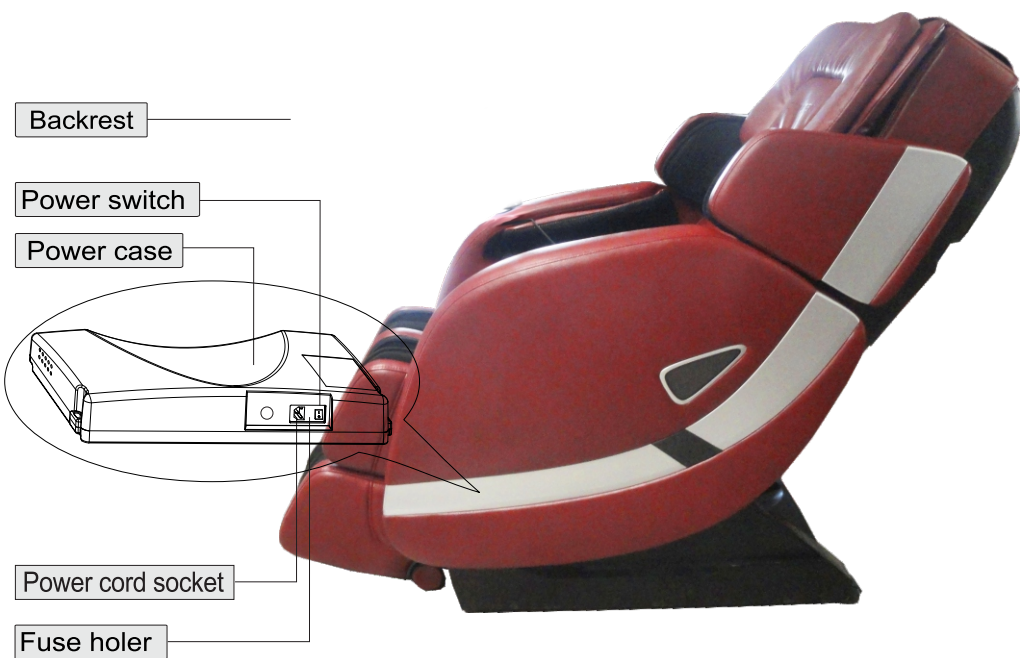

Preparation

Internal structure



Preparation

Explosion Diagram

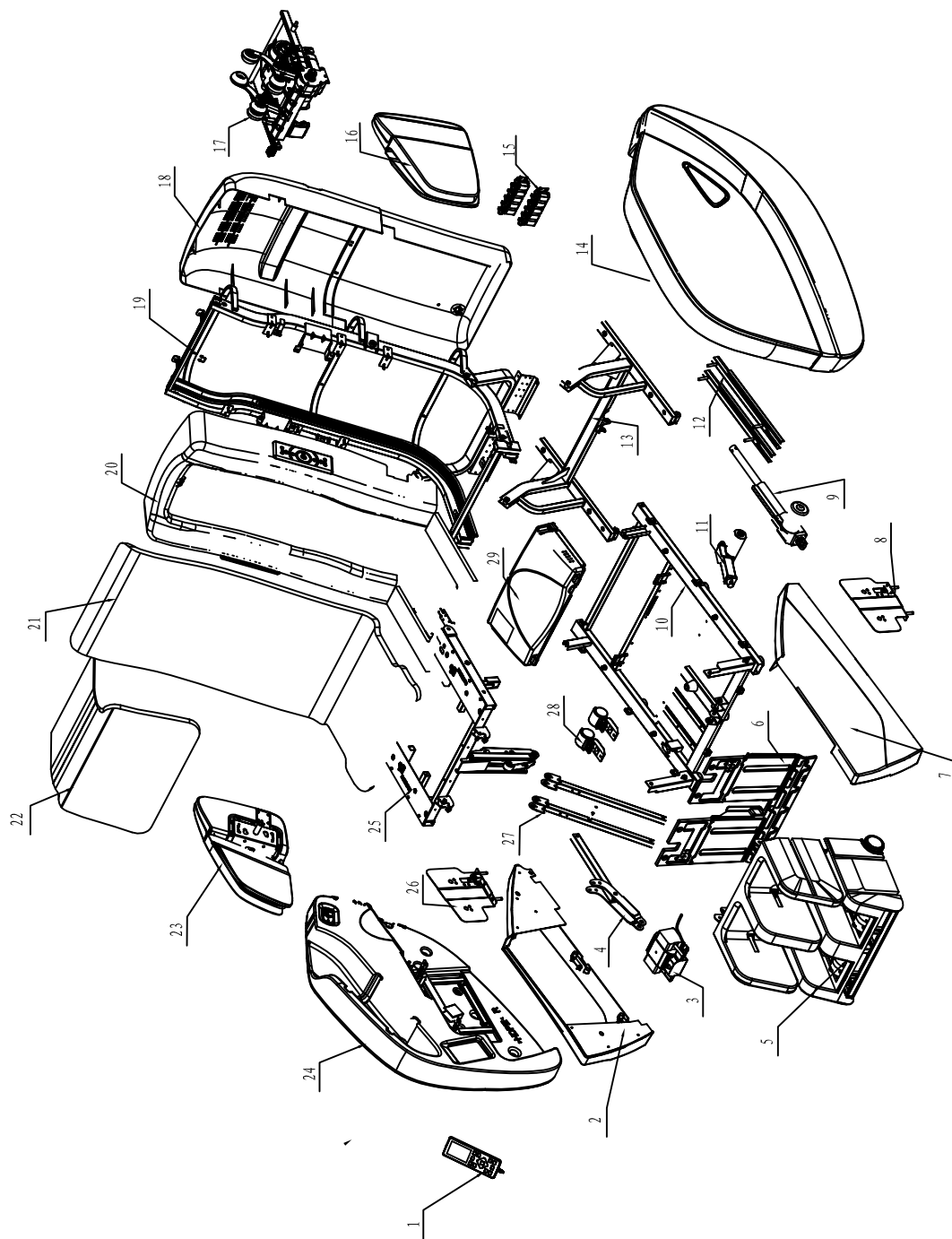

Preparation

Mechanical components list

NO.	Name	Q' ty	NO.	Name	Q' ty
1	Remote control	1	22	Pillow	1
2	Right side fender	1	23	Right shoulder massage device	1
3	Air pump assembly	1	24	Right armrest assembly	1
4	connecting rod	1	25	Seat frame surface assembly	1
5	Legrest & footrest	1	26	Right side of seat airbag assembly	1
6	Front fender	1	27	Seat support bar	2
7	Left side fender	1	28	Castor	2
8	Left side of seat airbag assembly	1	29	Power case assembly	1
9	Backrest electric actuator	1			
10	Bottom seat frame assembly	1			
11	Footrest electric actuator	1			
12	Sliding rail	2			
13	Top seat frame assembly	1			
14	Left amrest assembly	1			
15	Electric magnetic valve	2			
16	Left shoulder massage device	1			
17	Massage machine	1			
18	Back cover assembly	1			
19	Back frame assembly	1			
20	Backrest plastic front cover and seat plate assembly	1			
21	Back and seat cushion	1			

Preparation

Installation (1)

Step 1. How to move the chair

1 Take out the box which contains the shoulder parts first, then take the main chair body out of the carton box. To do this, have 2 or more people grasp the left and right metal seat frame and lift it out slowly. Note: Put the remote controller on the seat surface when taking out the main chair body to avoid damaging the controller.

2 Take out the head pad, back seat cushion, remote control holder, power cord, left and right seat airbags, and the left and right shoulder massage devices from the shoulder box, grasping two sides of the shoulder device and taking them slowly out. Put them on a table or on the ground. (be careful not to scratch them).



3 Take out the left and right armrest from the armrest box. Grab two sides of the armrest and take them slowly from the box. Note: Armrest is place upside down inside the box. Put the armrest on a table or on the ground. Be careful to not scratch the armrests.

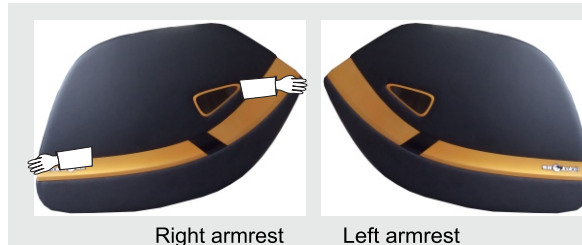

4 Take the legrest device out of the legrest carton box catching the front and back two sides of the legrest and remove it from the box.

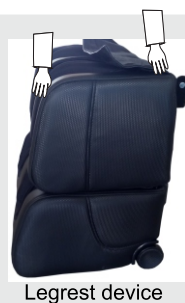

Step 2 massage chair position return

After take out the main chair body, ①Take out the power cord, insert one end of power cord to the socket on power box, another end insert into power socket.

②Turn on the power switch on power box, switch on the massage chair, backrest goes up and seat goes down.

③After backrest return, turn off the switch, unplug the power plug. (Refer to step 8, after the assembly)



Installation (2)

Step 3. How to assemble the legrest

Install the legrest to the main body, ①unscrew from hangers of legrest. ②connect 3 air pipes on legrest with air tap on main body, from left to right is grey, brown and black pipe. ③Connect power line with power socket tight. ④ raise the rotation shaft board on hangers, raise the legrest with hands, put rotation shaft into hangers on main body, and put rotation shaft board down. ⑤ screw it back tight.

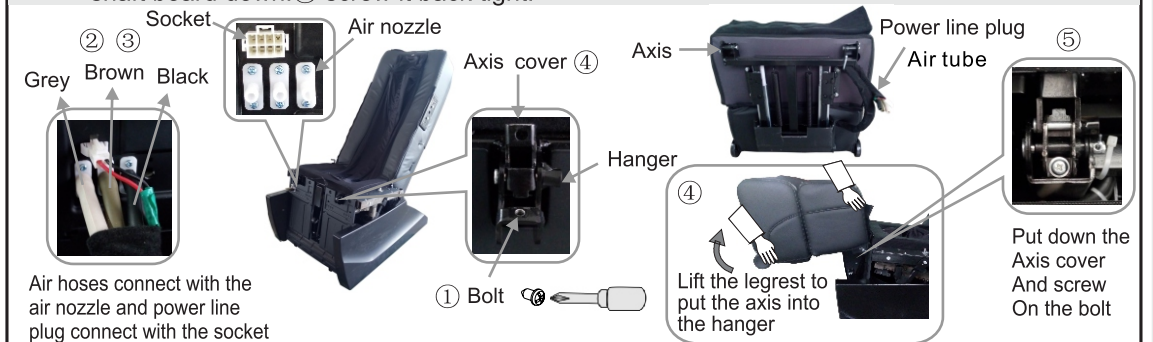

Step 4. How to Install the left and right armrests

①Unscrew the bolt on the seat frame with cross screwdriver. ②Press the button on the fixed hole which inside the back of armrest, insert the fixed hole into the fixed bolt of side backrest. ③Insert the square tube into the side piece of the seat frame. ④Slightly move the armrest to make them front and back panel match bolt hole on the seat metal frame, screw bolt on the hole. ⑤Connect air hose of the same color on armrest well to the ones from seat.

⚠ Take care the air pipe when assembling and avoid squeezing.
 ✦ Disassemble the armrest: Disconnect the air pipes between the seat and armrest, unscrew the four screws on the seat, lift up the front of armrest, let the square tube of amrest move out from the plate of seat frame; then press the button on the fixed hole which at inside of back of the armrest and pull the end of armrest at same time, move the fixed hole away from the fixed bolt which on the side of backrest, then it will finish to disassemble the armrest.

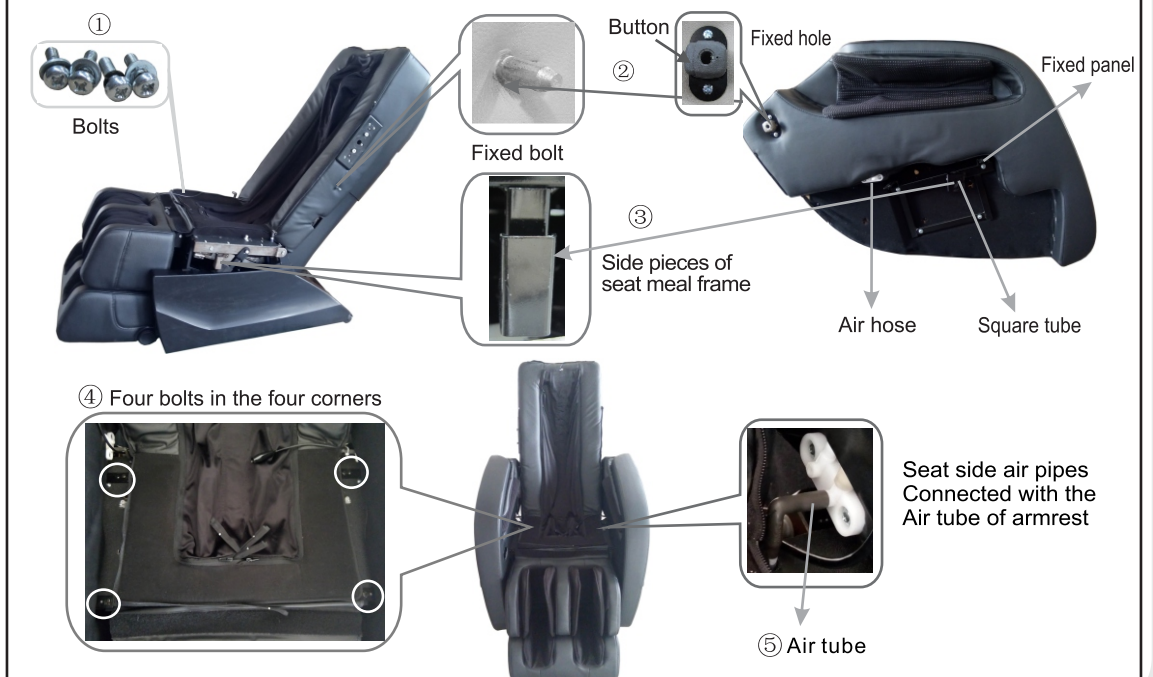

Installation (3)

Step 5. Installation of the side air bags of seat, remote control and controller holder

1 Take the right side seat airbag and make sure the zipper is facing the seat. Make the two cylindrical pins align to the two holes on the seat frame, then press down firmly and make sure the connection is tight.

2 Connect air pipe on the airbag with air tap behind the seat near the airbag. Make sure it is connected tightly.

Install the controller holder on the armrest and put controller in the pocket.

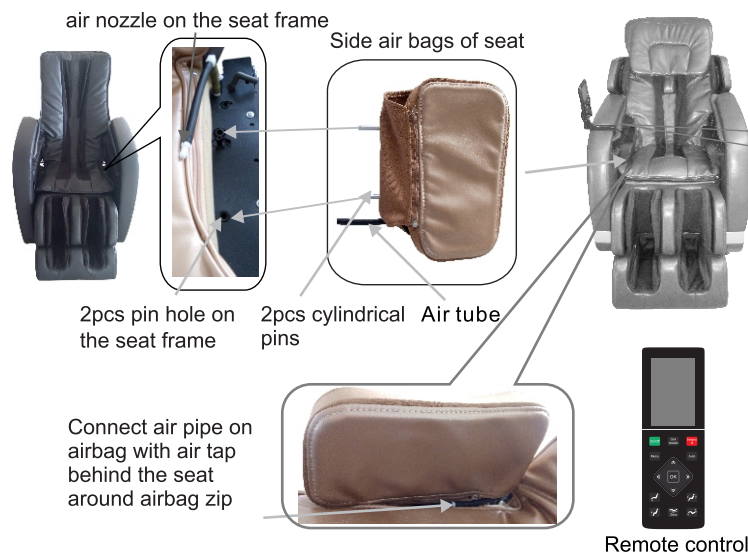

Step 6. Put the back

Cushion, head pad onto the backrest and connect the two parts with zipper and velcro.

★ Tech Tip:

In order to get exact correct body test data for comfortable massage effect, when you sit on the chair, please make the bottom rim of the head pad flush with your ears before zippering the said two parts.



Back seat cushion Head pad

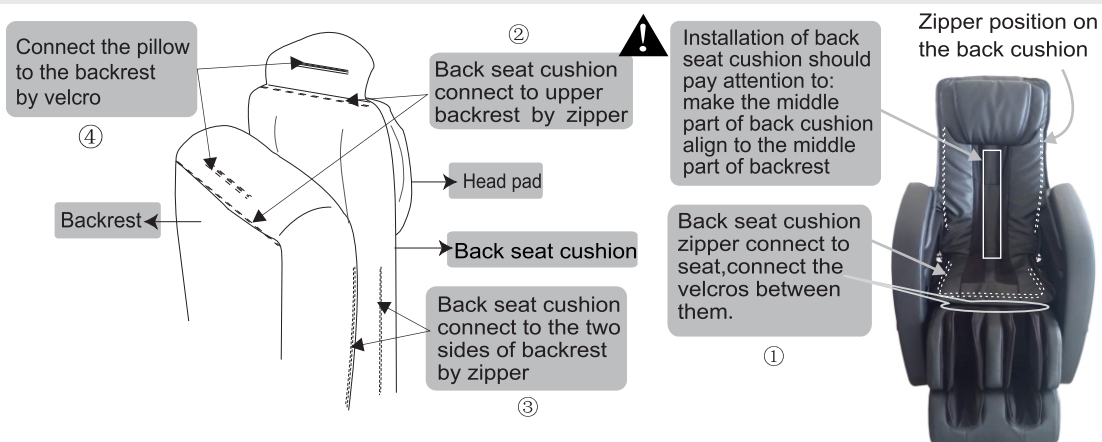

Installation (4)

Step 7. Assemble left/right shoulder parts

▲ Assemble left part onto the left side of the backrest, right part onto the right side of the backrest.

① Attach the shoulder part to the backrest side, ② Match the shaft to the hole on the side panel of the backrest, and match the two screw holes with the two step screws on the side of the backrest, insert the shoulder part onto the side of the backrest tightly. ④ Same way to assemble the other shoulder part.

Disassemble shoulder parts: Press down the hidden button at the back of the shoulder part, meanwhile, rotate the shoulder part upward to disassemble the shoulder part.

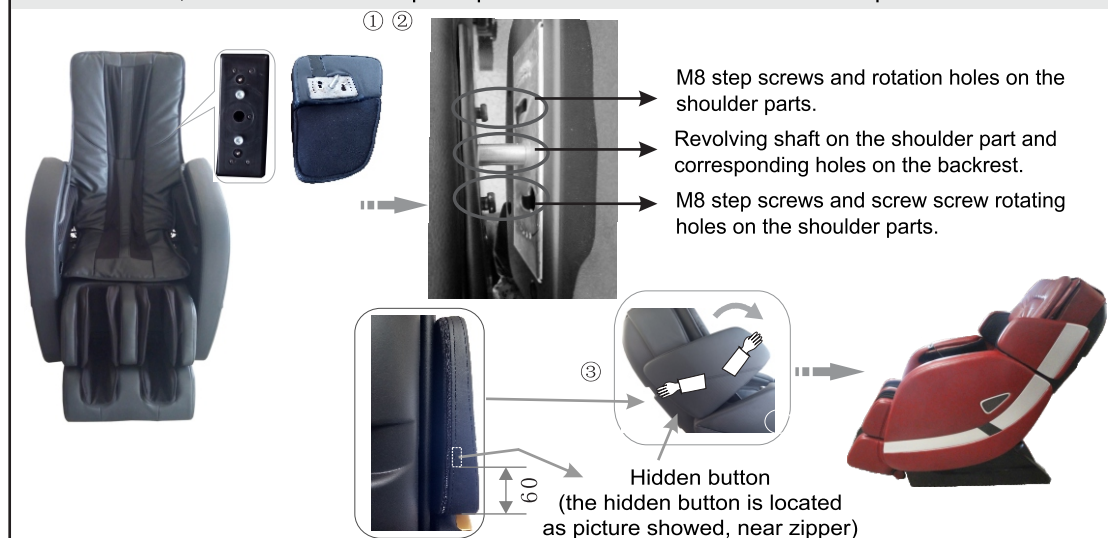

Step 8. After the Assembly

After the assembly, please operate the chair in this order:

- 1 Plug the cable line in the hole a on the power box as shown in the right picture.
- 2 Insert the plug of cable line into the socket.
- 3 Switch on. (Switch on/off "O/I", press I down to turn it on.)
- 4 Enjoy the massage by using the remote control.

⚠ Make sure the switch is off before you insert the plug of cable line into the socket.

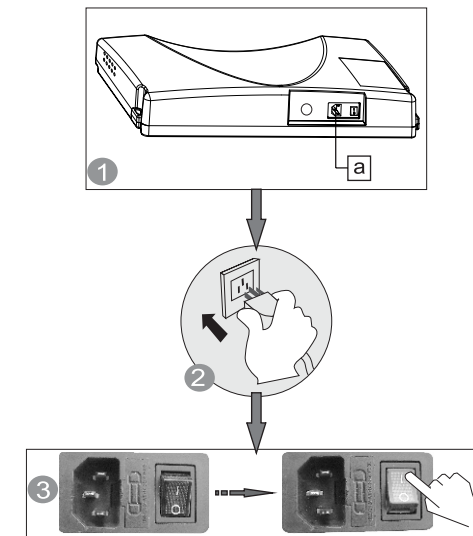

Environment

 Caution

Don't use the chair in wet places like near swimming pool, bath room to avoid leakage or electric shock.



Don't use under sunlight or near any heat source to avoid damaging the upholstery.



Please use chair on a flat surface to avoid unexpected noises or damage to the chair.

● Check places in front

Check the areas when back and leg extending, make sure no people, pets or other things around.



● Check power cable, plug

- 1 Clean dust from plug and cord (using a dry cloth).
- 2 Check there is no damage to cord anywhere.



Check environment

● Space size for using the chair

- At least 4 inches from the wall.



- At least 12 inches from the legrest.....

● Check surroundings

When the backrest or legrest reclines or extends, please pay attention to:

- (1) Check any person or things in every direction.
- (2) Check the space size.



How to move massage chair

 Caution

- ✦ Don't move chair when it's working in case of accidents or damage

How to move

- ✦ Bind the cables and put them in the seat to avoid damage when moving. Do not drop the chair, you may damage the electronics inside the chair.
- ✦ Don't use the castor wheels if the floor is wooden or easily scratched. You will need 2 or more people to lift the chair in this case.
- ✦ Make sure the power is off on the chair and that the plug unplugged and not dragging behind the chair.



Normally

- 1 Lift up the legrest to make the gravity fall on the castor. Then push chair to destination and set it down.

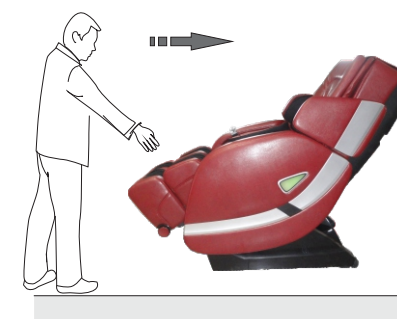

- ⚠ Please hold the footrest to move the chair as shown in the picture in case any scratches on the leatherette

Adjustment before massage

● Before adjustment

- ✦ Please make sure the massage unit is in the head area before sitting on the chair.



- ✦ To avoid injury caused by wrong position of massage unit.

- ✦ Back scan will not be effective if the massage unit can't detect position of your shoulders and head.

Right position: Your back cling to the chair back, the head clings to the pillow.



The remote control gives "beep" sound after acupuncture point tracking detecting finished, when micro-adjustment is needed, just press up/down key on the remote control.

● Kind suggestion

- ✦ When you feel the intensity isn't strong enough, take off the pillow or cushion.

- Because the chair is heavy, it can cause damage to flooring. Please put a blanket or carpet piece under the chair to protect the floor.



Manual control

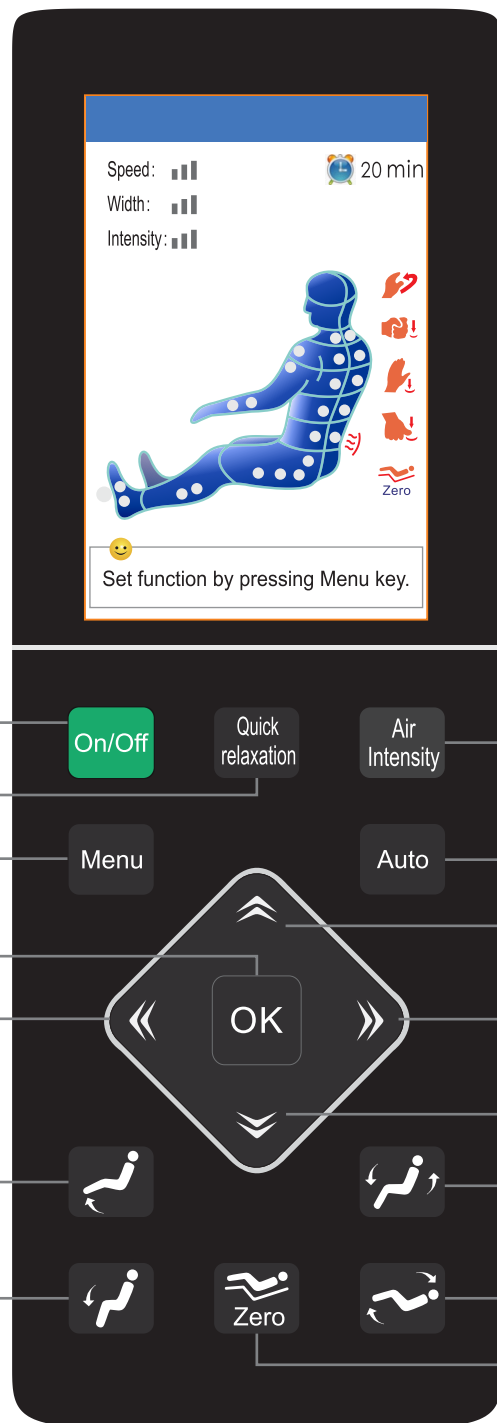

Massage operation

Massage operation

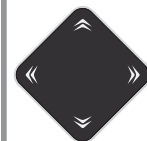

1. Press power switch button under standby status, massage chair enters ON status. Press Menu or button to choose massage program. In ON status, press power switch button, massage chair will turn off and return, massage machine automatic reset to the seat part, legrest stays in the lowest position, backrest stays in the highest position, controller will turn off after 3-5 seconds.
2. In ON status, press it to enter quick relaxation auto program, there is relative status screen display. Default massage time is 8 minutes. Press it again to stop.
3. In on status, press it to enter air intensity adjustment which has four levels. Each time press it, you can adjust the air intensity level and on the screen, you can see the intensity display.
4. Press this button in Main interface to switch to menu interface, user can set different function for massage chair. Press it in Menu interface to return to main interface.
5. In ON status, press it to switch an auto program each time, five auto program for choice: Recovery, Pain relief, Stretch, and relative screen display is shown on controller.
6. Direction button has 4 buttons, they are Up, Down, Left and Right. In Menu interface it is navigator button, user can press Up or Down to choose menu fast, and press Left or Right to enter previous or next menu. What's more, Up and Down button can be used to adjust massage position in acupuncture point tracking detecting finish and point massage.
7. In ON status and under Menu mode, press it to confirm menu choice and enter next menu.
8. Keep pressing this button, legrest goes up, release it, legrest stop moving. Controller screen will show position adjusting... when adjusting the position of massage chair.
9. Keep pressing this button, backrest goes up, legrest goes down, release it, backrest and legrest stop moving. Controller screen will show position adjusting... when adjusting the position of massage chair.
10. Keep pressing this button, legrest goes down, release it, legrest stop moving. Controller screen will show position adjusting... when adjusting the position of massage chair.
11. Keep pressing this button, backrest go down, legrest go up, release this button, backrest and legrest stop moving. When adjusting sitting position, it shows seat position adjusting... in controller screen.
12. In On status, press this button, massage chair will go into zero-gravity position, press it again to return to default position.

LCD display graphic description

Main interface

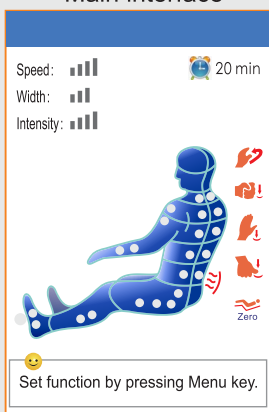

Press "on/off" button. When the chair powers up you will hear a short beep. The LCD screen will display the Infinity Logo and after 2-3 seconds it will display the main interface then enter standby mode. The main interface shows the massage position, method, time, heat, massage status, etc. All info is updated live.

- Message function
- Kneading
 - Tapping
 - Knocking
 - Pressing
 - Zero gravity
 - Massage time left

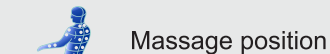

- Message speed (1,2,3,4)
- Message width (narrow, mid, wide)
- Air intensity (1,2,3,4)

Massage operation

Menu interface

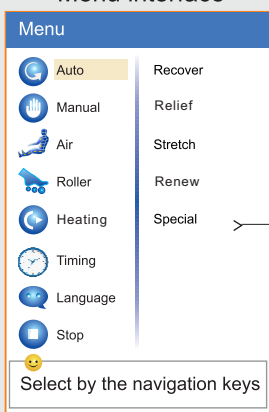

Press the "menu" button in the main interface and you will enter the menu interface. From here you can set the massage function. Press menu again to exit and return to the main menu interface.

Auto Massage: press the "menu" button and the cursor will stop on the auto massage program menu item by default. Press the "ok" button and you can choose the auto massage mode you like from a choice of five special auto programs.

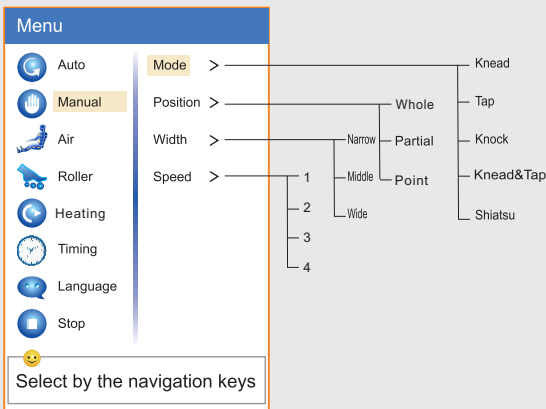

Manual : press "menu" key, select manual massage by the navigation key, press the "OK" button, there are four options: mode, position, width adjustment, speed adjustment: select the corresponding function, then press the "OK" button to enter the next menu, select the desired massage method, position, width and speed regulating function.

When massage chair in manual fixed point work modes, users can use up/down button to adjust massage position, information for "massage position adjusting..." will be shown at the bottom of the display screen.

LCD display graphic description

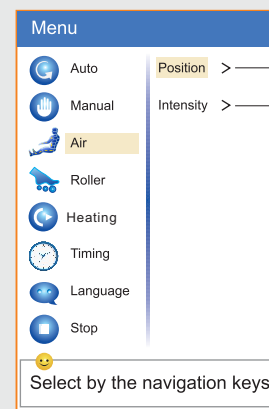

Air: After pressing the Menu button choose "air pressure" through navigation key, then choose "OK". There are two kinds of air pressure related function: Position and Intensity. Choose the function you desire then press "OK".

Roller: press "menu" button, select foot roller massage by the navigation key, press the "OK" button, Press "OK" button, choose rolling massage mode.

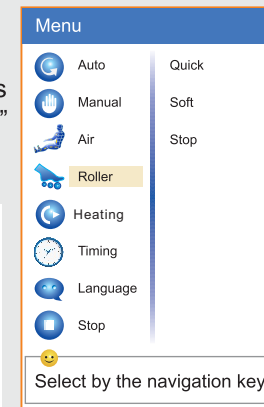

Timing: press "menu" key, through the navigation key to select menu item timing, can choose massage time: 30 minutes, 20 minutes, 10minutes, the default time is 20 minutes, the chair will turn off automatically after time is up.

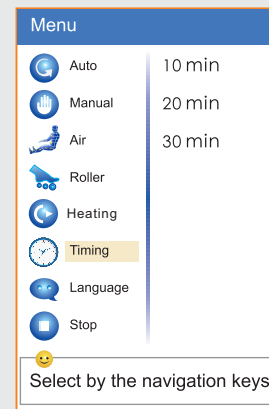

Language: press "menu" key, select language through the navigation key, then select the needed language.



Stop: press "menu" key, select stop through the navigation key, it will stop massage, and back to main interface.

Exit : press "menu" key, select back through the navigation key, will Exit menu, return to the main interface.



After powering on the chair and using an auto program, the chair will begin the computer controlled body scanning procedure. The screen will show "Body Scanning" until it finishes, when the chair will let out 5 tones in 5 seconds to let you know it is complete. At this time the massage rollers will be located in the position they determined is your shoulder position. If you think the position is not correct, you can press the "up" and "down" buttons to adjust the position. Default massage time is 20 minutes. The INFINITY Escape will turn off and return to its default position when the massage is over.

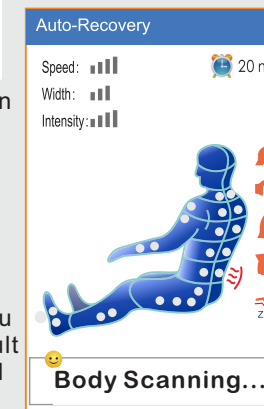

Massage operation

ON/OFF

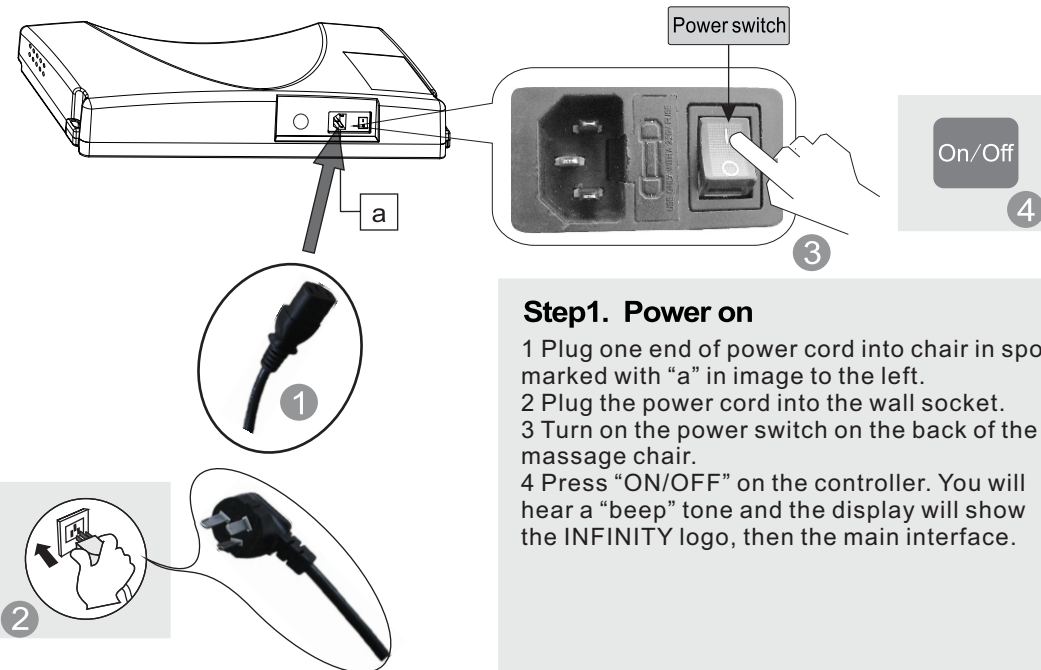
**Step1. Power on**

- 1 Plug one end of power cord into chair in spot marked with "a" in image to the left.
- 2 Plug the power cord into the wall socket.
- 3 Turn on the power switch on the back of the massage chair.
- 4 Press "ON/OFF" on the controller. You will hear a "beep" tone and the display will show the INFINITY logo, then the main interface.

Step2. Massage

1 Operate according to the controllers operation instructions.

2 When the massage is over, the massage chair will return to its default position. The remote will show "Shutting Down", then the chair will power off.

**Step3. Turn off the power**

- ① When the chair is On, press On/Off button to turn off the massage chair and it will restore automatically.
- ② Turn off the power switch on the bottom of the back of chair after the rollers stay at storage position.
- ③ Unplug the power plug from the socket.

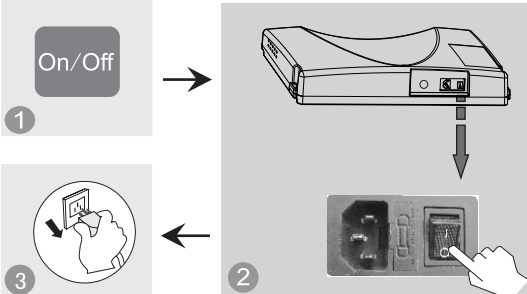
**Warning**

1. Before using, pull up the pillow, back cushion etc. to check if the PU material is broken, if there is damage, please stop using, unplug the chair, and ask for repair
2. Only plug to proper socket.

**Attention**

- 1 Before using chair, please make sure there are no objects between cushions, under legrest, on the seat, etc.
- 2 Make sure the chair is in its default off position before sitting in chair.
- 3 Do not stand on chair when using it.

Function Illustration

● Legrest Up

Press this button on controller, legrest goes up. Release the button, legrest stops moving, the angle is locked in this position.

**● Legrest extend and retract**

Legrest can extend or retract within a range of 6 inches.

**● Legrest Down**

Press this button on controller, legrest goes down. Release the button, legrest stops moving, the angle is locked in this position.

**● Arm massage**

Put arms between the arm airbags before the airbags inflate. The chair will perform pressure massage techniques to arms and hands during the massage after the airbags inflate.

**● Legrest up and backrest down**

Press this button on controller, backrest go down and legrest go up. Release this button, backrest and legrest stop moving, the angle is locked in this position.

**● Shoulder massage**

Multilayer airbags are used on both shoulders. These airbags provide air pressure massage and relieve shoulder fatigue.

**● Backrest up and Legrest down**

Press this button on controller, backrest go up and legrest go down. Release this button, backrest and legrest stop moving, the angle is locked in this position.

**● Foot roller massage**

The footrest provides roller massage and air pressure massage functionality. By stimulating the foot reflex zones the footrest provides amazing relaxation of the feet, and reduction of stress in the whole body.

**● Zero gravity**

Press the "Zero" button to activate zero gravity mode, where the back of the chair will go down and the legrest will go up into a position where gravity is equal on all parts of the body, also known as zero gravity, developed by NASA for astronauts on space missions.

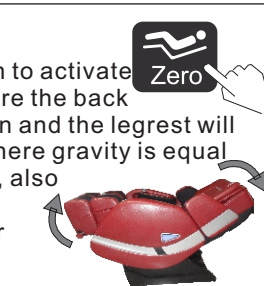

- 1 Please make sure there are no people, pets, or objects within the range of the backrest to avoid damage to chair or external objects .
- 2 When the legrest is moving do not stand on or leave the chair. Do not attempt to stop the legrest or backrest from moving or you may damage the chair.
- 3 Please refer back to these instructions for more details.

Restoration of massage chair

- 1 Make sure there is no people or pet or anything within the range of backrest and legrest.



- 2 Make backrest and legrest restore to the normal position by controller. (or press ON/Off key to make backrest and legrest restore to the normal position)



- 3 After restoring, put the controller back to the controller bracket.



- 4 Put the pillow pad on to the right position.

- 5 Switch off the power.

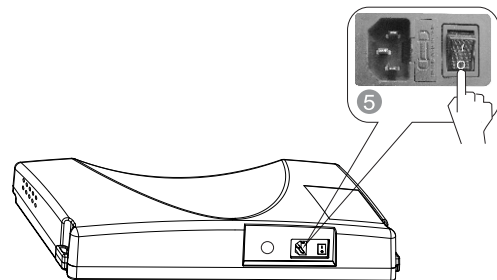

- 6 Unplug the electricity from the socket. (Attention: hold the right plug position)

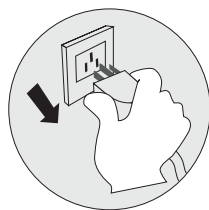

- 7 Clean the chair if necessary.



Attention!

- After using chair press the On/Off button to end massage and wait for full reset.
- Make sure to unplug the chair from electricity to avoid unexpected injury to children or pets.
- After using chair, turning off the power and unplugging from wall, check the power cord for moisture, damage, cracks, and replace if needed.

Synthetic leather

● General cleaning

Clean with tidy, soft, and dry cloth.



(Chemical or medical cleaning products are forbidden)



● If Vinyl is dirty

- 1 Dip soft cloth into 3-5% neutral detergent solution, squeeze it then clean the stain on the surface gently.
- 2 Wash cloth, squeeze it and wipe with detergent.



- 3 Clean it softly with dry cloth.
- 4 Allow to dry (air blower is prohibited)

Cloth material

- 1 Dip cloth into weak neutral detergent, squeeze it and clean

● the material surface.

(Diluent, gas, alcohol are prohibited)

Brush the dirty parts with weak neutral detergent. (avoid excessive brushing)

- 2 Excessive cleaning may cause damage to cloth material.
- 3 Wipe with water-dipped but squeezed cloth.
- 4 Allow to dry.



Plastic parts

- 1 Dip cloth into neutral detergent, squeeze it and clean.
- 2 Wipe with water-dipped but squeezed cloth.
- 3 Allow to dry.



Clean the controller

- 1 Wipe with soft cloth after squeezing.
- 2 Allow to dry. Propellant, diluent or alcohol are prohibited.



About cleaning

- Before cleaning, unplug the electricity, don't touch plug with wet hands.
- Make sure hands are dry when plugging to the socket.
- If failed to follow the mentioned instruction, user may get electric shock or burned.

FAQ and Troubleshooting

Trouble	Possible reason	Troubleshooting
The massage chair can't work after power is on.	Check if the control is on or not.	Open control switch
	Not choose massage function	Choose massage function
	Check whether the plug and socket in poor contact.	Make sure plug and socket are connected.
	Wire or plug has damaged.	Please ask manufacturer or appointed or authorized maintenance man for checking and replacement.
	The fuse burned out.	Replace fuse of same specification.
	Something wrong with inner circuit	Please ask appointed or authorized maintenance man for checking and repairing.
There is beep sound inside the massager while working.	It is sound of air pump, motor and mechanical parts.	Normal sound, no need to pay attention to it.
Different height of the left roller and right roller.	Massage rollers work on shifts.	Normal, no need to pay attention to it.
Sound suddenly becomes much louder while working.	Check if it is due to long time working.	Turn off the power to have the massager rest for over half an hour before next turn working.
	Inner parts fretted away due to long time work. It's normal	Please ask appointed or authorized maintenance man for checking and repairing.
Massage function suddenly stops while working.	Suddenly power-down	Connect the electricity power again
	Setting time is up.	Turn off the power to have the massager rest for over half an hour before next turn working.
Neither the backrest nor the legrest can be lay down.	Check if there are any obstacles; the chair overloads; for the sake of safety, sometimes the massage machine may automatically stop working.	Remove the obstacles; turn off the power to have the massager rest for over half an hour before next turn working.
The chair can't return to its original position.	Excessive operation; setting time is up.	Please ask manufacturer or appointed or authorized maintenance man for checking and replacement.
Electric wire or plug give out heat	It may work overload	Turn off the power to have the massager rest for over half an hour before next round working.
	Other abnormal case	Stop using, and ask appointed maintenance man for help.



Note: If the troubles are not caused by above reasons, please turn off the power switch and cut off the power, then contact the manufacturer or service agent to repair your chair.

Technical data

Name	INFINITY	Power	200W
Model	Excape	NW/GW	Main body: 161lb/220lb Armrest: 43lb/59lb Legrest & Footrest: 38;b/45lb
Input voltage	<input type="checkbox"/> AC120V, 60Hz <input type="checkbox"/> AC220V, 50/60Hz <input type="checkbox"/> AC240V, 50Hz		
Safety design	Class I	Packing size	Main body: 49x25x31 Armrest: 34x13x27 Legrest & Footrest: 18x15x18