



## **APEX AP-Pro Regal User Manual**

*Make your life healthy  
and beautiful every day!*



Please read SAFETY INSTRUCTIONS carefully before using the chair.

## AP-Pro Regal With 3D technology Function Introduction

1. With intelligent 3D massage technology it covers the neck, shoulders, upper to lower back and waist with incredible accuracy and consistency. The 3D massage provides a life like massage like no other with an added top shoulder massage. The Arms of the massage heads extend out to massage the tops of the shoulder pressing down in a kneading action.

2. The advanced computer body scan allows for the chair to map out the vital areas of the back to ensure an effective massage. The massage heads will adjust to various heights and curvatures giving you your own custom massage.

3. The chair can recline and raise the leg rest independently from each other. This allows the user to adjust the chair to the most desirable position.

4. This chair has SPACE SAVING technology so that when the chair reclines it only requires 4-5 inches of additional space. This reduces the amount wasted space behind the chair.

5. With its built in MP3 player you can enjoy your own personal selection of music. The music must be converted to MP3 format in order to listen to be heard on its high definition speakers located at the sides of the backrest.

6. The foot massagers are equipped with innovative foot rollers and air bags that compress the feet. This mimics a hand kneading massage.

7. This chair is equipped with a patented reflexology technology, multiple air bags that firmly grab the feet and calves, stretching the calves and legs.

8. The air bags located in the arms apply pressure squeezing and massaging arms.

9. The seat is equipped with multiple air bags that soothingly squeeze the hips.

With the combination of the massaging roller heads and air bags in the backrest, it allows for those hard to reach areas to receive a deep massage.

10. The legrest extends out for the taller user and can be adjusted to your desired angle. The legrest has a limited range of motion and can be raised to almost a parallel position to the ground.

11. The high resolution remote allows the user to see what the chair is doing in live time.

- ★ Thank you for choosing the AP-Pro Regal Regal Massage Chair. Please read this manual very carefully before using the massage chair.
- ★ Do not dispose of this manual so that you may have it for future reference on safety, operations and functions.



### Content

<b>Preparation</b>	Safety instructions ..... 1
	External structure parts ..... 5
	Internal structure parts ..... 6
	Mechanical components diagram ..... 7
	Mechanical components list ..... 8
<b>Installation</b>	Installation ..... 9
<b>Massage Operation</b>	The adjustment before massage ..... 13
	Manual control ..... 15
	Operation instruction & function illustration ..... 19
	After massage ..... 21
<b>Maintenance</b>	Clean and maintenance ..... 22
<b>Others</b>	Troubleshooting guide ..... 23
	Technical data ..... 24





Please keep this manual in a safe place for future reference.

- Please read this manual carefully to make sure the installation and operation of the massage chair is correct.
- “Safety Instructions” is provided in both Warning and Caution for important safety information.

Both Warning and Caution are important safety caution, please pay more attention.

 <b>Warning</b>	This symbol indicates to proceed with extreme caution. May lead to serious electrical injury or death.
 <b>Caution</b>	This symbol indicates to be very careful with this area of the massage chair or damage to the product may occur.

### Symbol meaning

	This sign indicates forbidden behavior.		This sign indicates self disassembly is forbidden.
	This sign indicates must follow instruction to operate.		This sign indicates correct operation of cable.

- The following should be kept for any further references.



## Warning

- Anyone with a medical condition or has surgery or any medical device implants can NOT use this chair unless recommended by your physician. People with pacemakers should NOT use this product because it has magnetic fields from the electric current.
  - Children, youth should NOT use this chair.
  - Do NOT use this chair to sleep in.
  - If you have been drinking do NOT use this chair.
  - During the use of this chair if you feel discomfort, immediately stop using the chair and contact your doctor.
  - Make sure there are NO children or pets within a 3 foot radius of the chair when in use. When the legrest and backrest are in motion it may cause serious injury.
  - Be sure not to allow the massage heads to massage above the neck. If you have any ailments do NOT use this chair without the approval of a doctor.
  - Ensure the chair is being plugged in to the proper power supply. We HIGHLY recommend that you plug the chair into a surge protector. Make sure all plugs are firmly inserted.
  - When plugging or unplugging the chair, the power switch in the back of the chair should be in the OFF position.
- 
- Do NOT fold or crease the seat cushions or any of the pads for storage.
  - Do not have the chair run for long period of time. It is recommended that the chair be turned off after 1 hour and allow for 30 min. to cool down.
  - If you see any visible damage to the power plug refrain from using the chair and contact the manufacturer.
  - Do not twist, lay on top any objects on the cord.
- 
- Do NOT fold or crease the seat cushions or any of the pads for storage.
  - Do not have the chair run for long period of time. It is recommended that the chair be turned off after 1 hour and allow for 30 min. to cool down.
  - If you see any visible damage to the power plug refrain from using the chair and contact the manufacturer.
  - Do not twist, lay on top any objects on the cord.

**Caution**

!	<ul style="list-style-type: none"> <li>Please operate the chair in a flat or level place</li> </ul>	To avoid sudden falling.	
	<ul style="list-style-type: none"> <li>Position the chair 40cm from the wall to allow for sufficient space to recline up and down.</li> </ul>	To make sure the back lying.	
	<ul style="list-style-type: none"> <li>The maximum suggested usage of the chair is 20 minutes per day. Any prolonged massage in the same area may cause injury.</li> </ul>	Too long time massage is bad for your body.	
	<ul style="list-style-type: none"> <li>Before sitting on the chair to avoid injury please inspect everything to confirm that the massage heads are in the correct position.</li> </ul>	To avoid accidental injury.	
	<ul style="list-style-type: none"> <li>Please make sure that the power switch is at the "OFF" position before inserting the plug into the socket.</li> </ul>		
	<ul style="list-style-type: none"> <li>Turn off all controls before removing plug from outlet.</li> </ul>	To avoid the accident when turn on the power.	
	<ul style="list-style-type: none"> <li>Make sure the plug is completely inserted in the socket.</li> </ul>	To reduce short circuits and any fire hazard.	
<ul style="list-style-type: none"> <li>Check whether there is any damage to the power cord. Makes sure it is dry.</li> </ul>	To avoid electric shock in any leakage or breakdown.		
<ul style="list-style-type: none"> <li>Before plugging in the power cord it is recommended that a surge protector is used. Make sure the ground prong is not damaged.</li> </ul> 			
⊘	<ul style="list-style-type: none"> <li>Don't press with hands or step on the massage heads with feet.</li> <li>Don't put hands between the working massage heads.</li> <li>Don't put hands or feet in the gap of mechanical parts.</li> <li>Don't drop or embed anything into the slot of massage chair.</li> <li>Don't stand or sit or put anything on the backrest, armrest or leg-rest.</li> <li>Don't stand on the chair during operation.</li> <li>Don't move the chair during operation.</li> <li>Don't pull out the plug or turn off the power during operation.</li> <li>Don't put your hands or head between leg-rest or beneath.</li> <li>Don't use the massage chair while wearing hair ornaments.</li> <li>Be sure all hard and pointy objects are removed from your pockets prior to using the chair.</li> <li>Do not press down on the massage roller with foreign object, feet or hands. Any sudden pressure that exceeds the weight limit may cause serious damage to the chair.</li> </ul>	To avoid accidents or injury	
	⊘	<ul style="list-style-type: none"> <li>Keep the chair away from heat, liquids, sharp objects, corrosive chemicals and humid areas.</li> <li>The use of electrical blankets is FORBIDDEN to be used with this chair.</li> <li>Keep this item away from the stove, oven, fire places, direct sun light and other hot areas.</li> <li>This chair is intended for indoor home use only</li> </ul>	To avoid fade, discolor on upholstery or hardened, deteriorated on PU.

**Caution**

⊘	<ul style="list-style-type: none"> <li>Do NOT use or store this chair in humid areas such as by the swimming pool, bathroom, sauna and air vents.</li> <li>The remote and the chair must be dry at all times.</li> <li>Be to be fully clothed and dry before using the chair.</li> </ul>	To avoid leakage or electric shock.
	<ul style="list-style-type: none"> <li>Make sure the plug is properly inserted into the surge protector. It is imperative that the ground wire and the cable is not damaged in any way.</li> <li>Make sure the plug is inserted into the proper power outlet.</li> <li>Do NOT use any type of power converter.</li> <li>If the cord is damaged in any way stop form using the chair and contact the retailer you purchased from.</li> </ul>	To avoid electric shock.
⊘	<ul style="list-style-type: none"> <li>Unplug the power before cleaning the chair.</li> <li>Unplug the power after using the chair.</li> </ul>	To avoid electric shock or fire harzard.
	<ul style="list-style-type: none"> <li>Unplug the power when any damage on the power.</li> <li>Hold the plug to unplug the power but not try to pull the wire to unplug the power.</li> </ul>	
	<ul style="list-style-type: none"> <li>Please turn off the power switch and unplug the power after massage.</li> </ul>	To avoid accidents
⊘	<ul style="list-style-type: none"> <li>Unplug the power immediately when electricity goes off.</li> </ul>	To avoid damage or accidents when power on again.

**Grounding instruction**

- ✦ ※The chair is equipped with a cord having an grounding conductor. The plug must be plugged into an appropriate socket that is properly installed and matched with the plug.

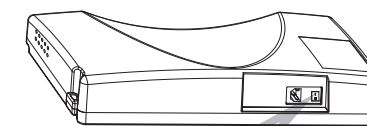
**Replace fuse**

- ✦ ※If the chair stops working and there is NO power getting to the chair or remote, the first thing to do is locate the fuse at the bottom base of the chair by the power switch. Remove the fuse to see if the fuse has popped. Using the same size and rated fuse please insert into the fuse slot. Proceed to put the cover on.

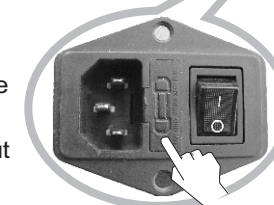

  
Earth wire is not allowed to be in these places

Gas pipe: probably cause explosion or fire.  
Phone wire and lightning rod: probably cause electric shock and fire when thundering.  
Water pipe: earth wire is useless where there are plastics

External structure



Preparation



Internal structure

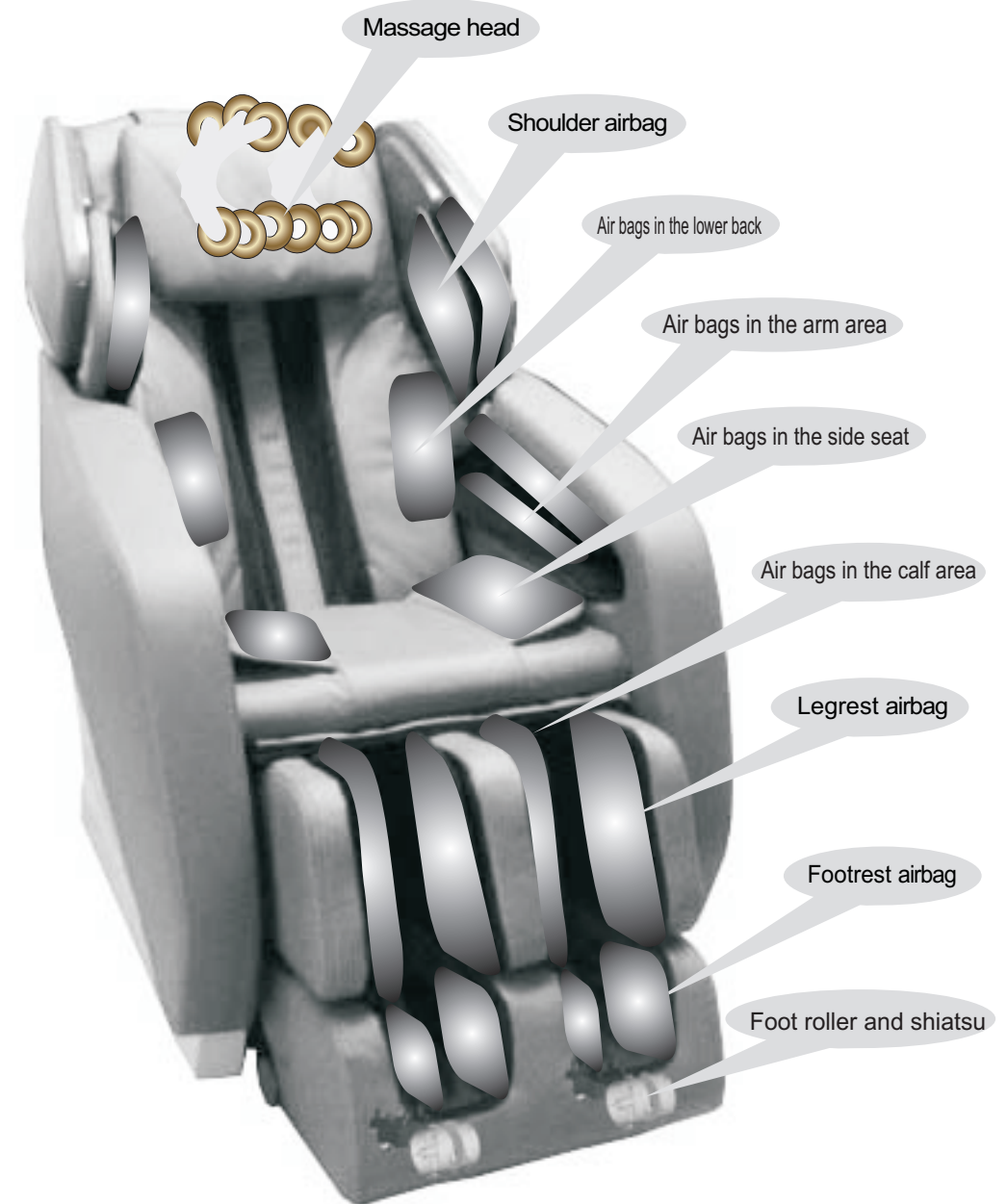

Preparation

Explosion Diagram

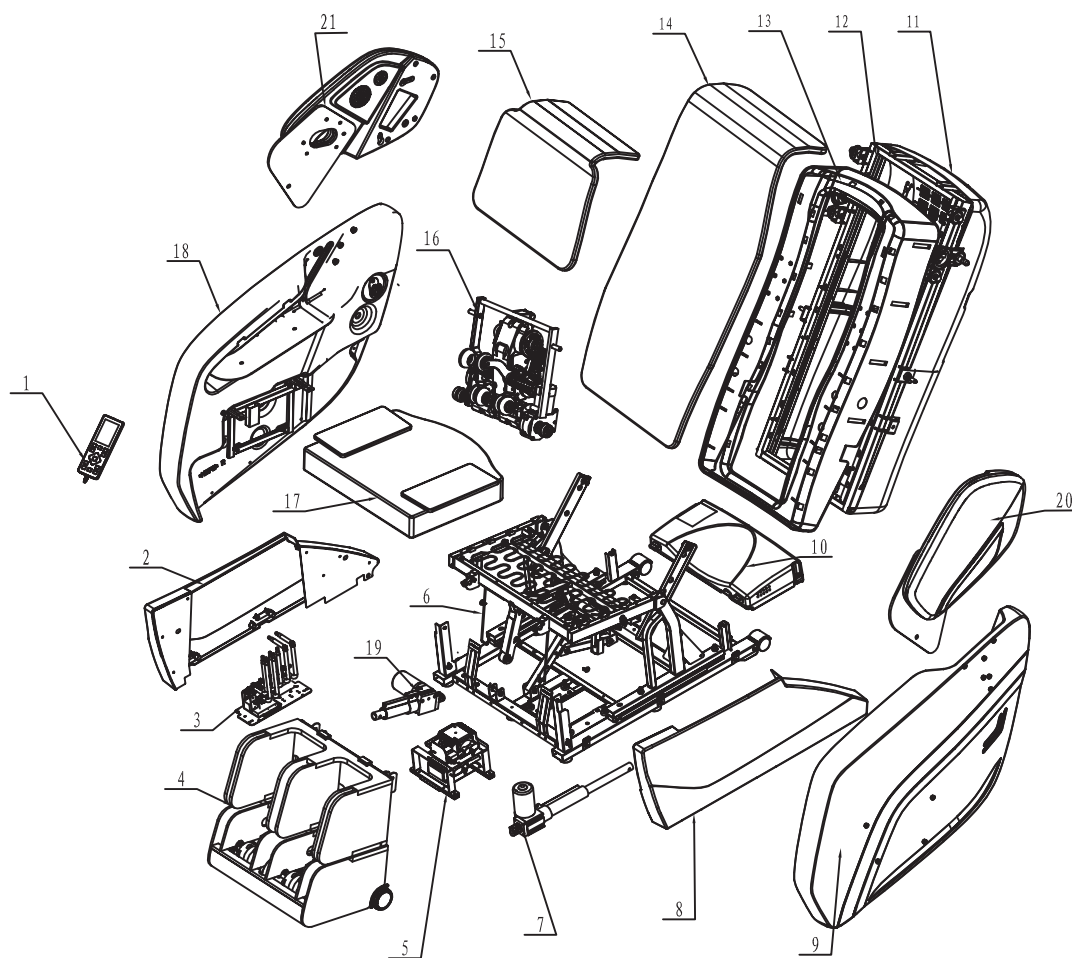

Preparation

Mechanical components list

NO.	Name	Q' ty			
1	Remote control	1			
2	Right side fender	1			
3	Electric magnetic valve	1			
4	Legrest & footrest	1			
5	Air pump case	1			
6	Seat frame	1			
7	Forward sliding electric actuator	1			
8	Left side fender	1			
9	Left amrest assembly	1			
10	Power case assembly	1			
11	Back cover assembly	1			
12	Back frame assembly	1			
13	Plastic front cover	1			
14	Back cushion	1			
15	Pillow	1			
16	Massage machine	1			
17	Seat cushion	1			
18	Right armrest assembly	1			
19	Legrest and foot electric actuator	1			
20	Left shoulder massage device	1			
21	Right shoulder massage device	1			

Preparation

## Installation (1)

## Step 1. How to move the chair

① When setting up the chair, 2 or more people are required. When moving be sure the seat & back cushions are removed along with the power cord any other loose items to avoid tripping and injury. Lift the chair as shown below in the illustration.

(as shown in the picture)

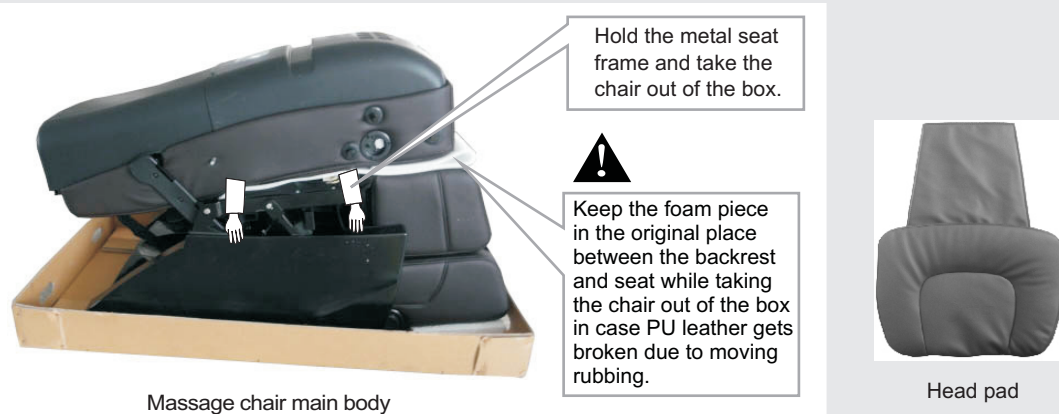

Seat cushion



Electric power cable



Back cushion

② Take out the left and right shoulder massage device, left and right armrests from the armrest carton, make sure to grab two sides of shoulder massage device and armrest slowly (armrest is put in upside down in carton); Put shoulder massage device and armrest flat on table or floor (do not scratch armrest), when assembling the armrest, grab two sides of armrest as shown in picture and lift up.

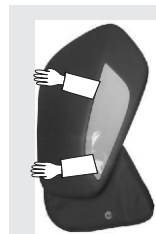

Left shoulder massage device (Inside with "L" Marks)



Right shoulder massage device ( Inside with "R" Marks)

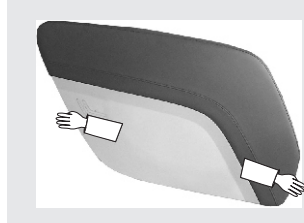

Right armrest



Left armrest

## Installation (2)

## Step 2. How to assemble the backrest

As show in the illustrations below, raise the backrest to the upright position until you hear a clicking sound. Once it has clicked, that confirms that the backrest has been locked correctly. Gently rock the backrest forward and back to make sure it is stable.

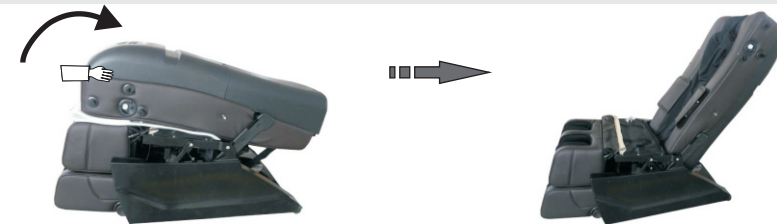

## Step 3. How to assemble the left and right armrest

⚠ Prior to starting make sure the remote is located which found in one for the foot massaging slots. Next step unscrew the M6 bolt on the seat base. Then match up the metal rod into the intended hole shown below in sequence 2. On the side panel there is a square rod that has to be inserted the frame of the chair (sequence 3). Once the side panels are attached to the frame proceed to secure the side panels by screwing in bolts. Be sure the holes match up before inserting the bolts. Then connect the wire that powers the LED lights on the side and the rubber tubes. Make sure the wire is NOT caught between the side panel and base. Also make sure the tubes are not twisted nor folded anywhere.

⚠ **How to disassemble the armrest:** Remove the shoulder massagers before removing the side panels. Unscrew the 4 bolts on the side panel that are connected to the base. Then disconnect the LED wire and the rubber hoses. Then lift up the side panel to remove from the track. Be sure to keep the loose bolts in a safe place.

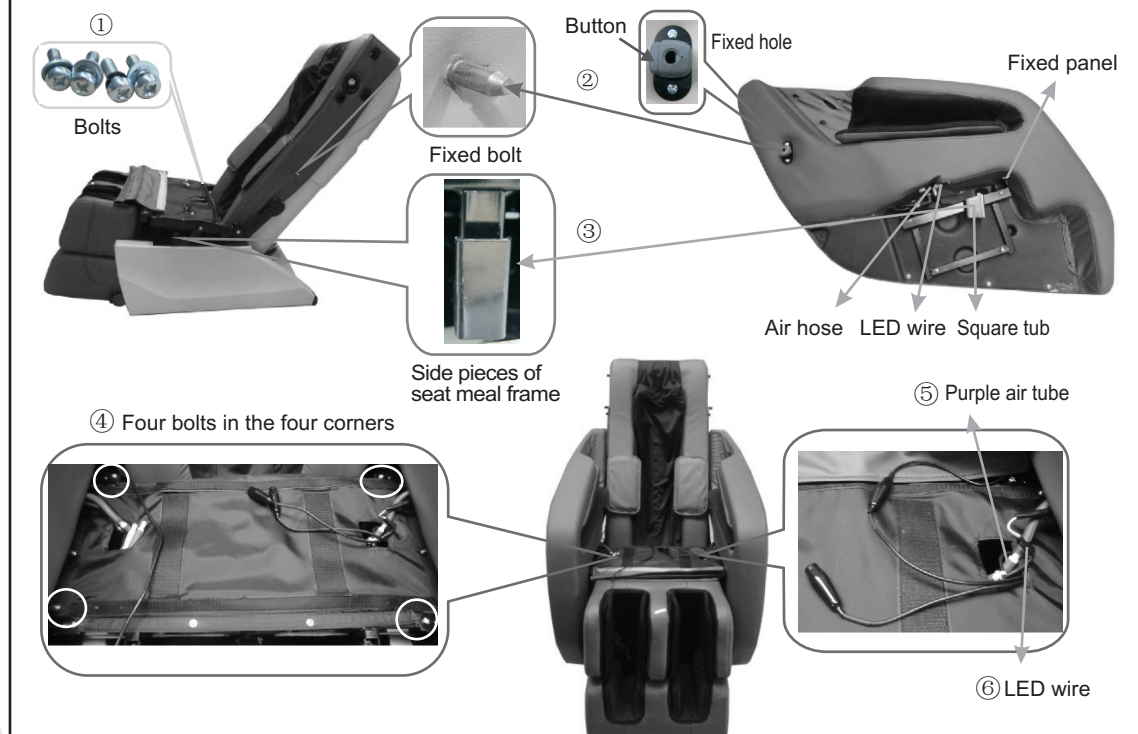

## Installation (3)

**Step 4: Install left and right shoulder massage device**

▲ Before mounting the shoulder massagers be sure to identify which shoulder massager belongs to which side of the backrest. Remove the screws that have been pre-inserted to its respective holes. Then connect the speaker wire and air hoses. Be sure the wires and the tubes are not being squeezed or folded to ensure proper function. Next step is to screw in the bolts that were previously removed. There are 3 holes on each shoulder massage. Be sure the holes match up with the holes on the backrest. Before fully tightening the bolts be sure the shoulder massagers are pushed down to its lowest position. Once that is confirmed tighten the bolts so that it does not move. Then cover the metal plate by zipping up the fabric cover. This completes this portion of the assembly

★ **Disassembly of the shoulder massagers:** Do the reverse steps from the installation instructions.

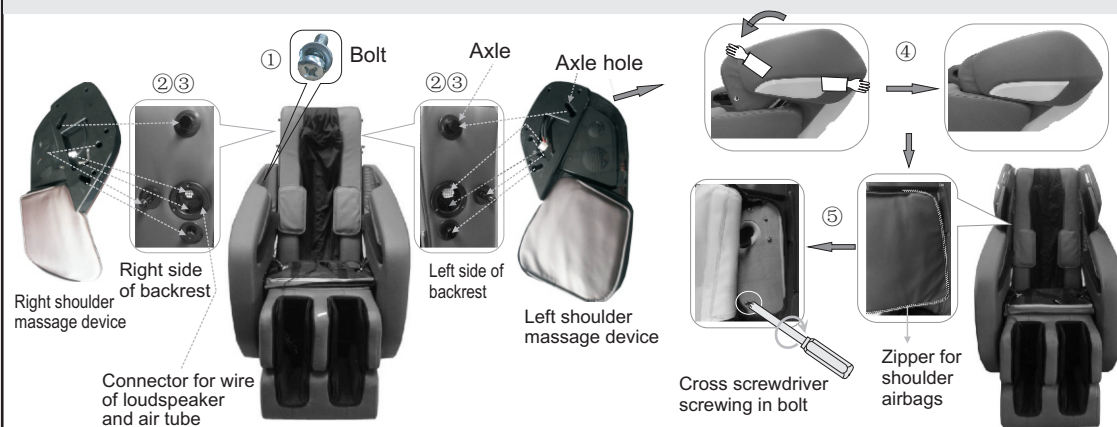
**Step 5. Put the back**

Mount the back pad to the backrest using zippers and Velcro.

★ **Warm tips**

Before starting the massage be sure that you set yourself in the desired position before selecting the massage program. This will allow the computer body scan to get an accurate reading.

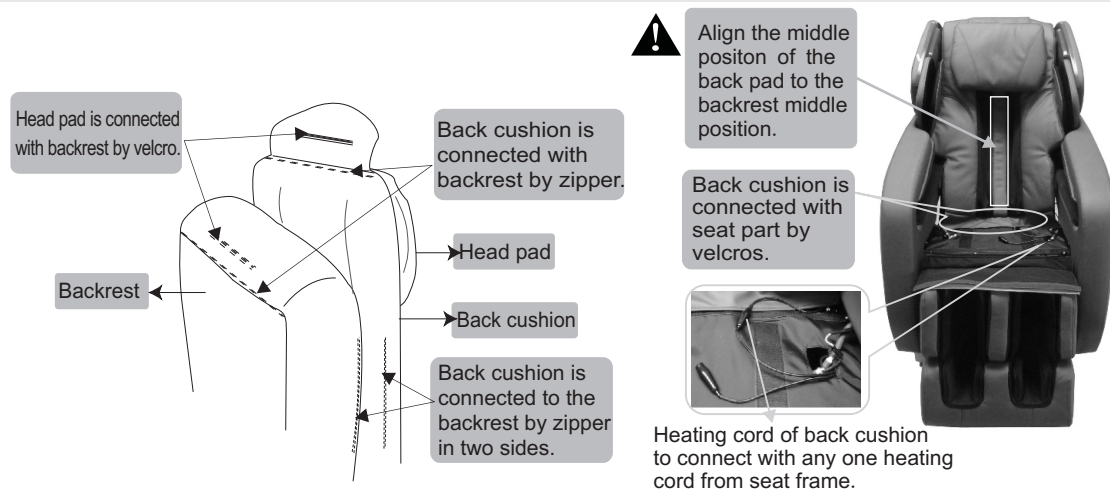

## Installation (4)

**Step 6. Connect methods for seat airtube and heating cord.**

Connect the air hoses and heating wire to the seat base of the chair. The air hoses are color code to ensure the correct hoses are connected.

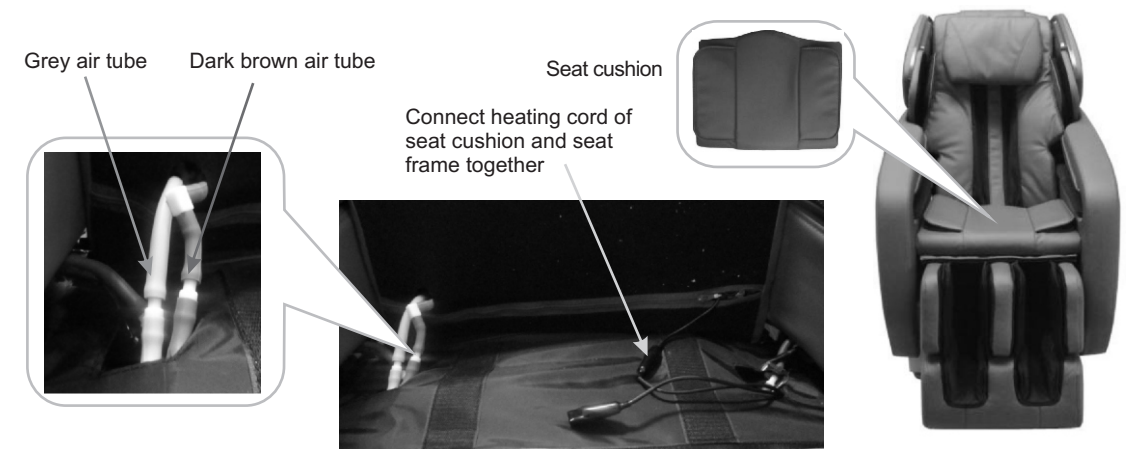
**Step 7. After the Assembly**

After the assembly, please operate the chair in this order:

- 1 Plug the cable line in the hole a on the power box as shown in the right picture.
- 2 Insert the plug of cable line into the socket.
- 3 Switch on. (Switch on/off "O/I", press I down to turn it on.)
- 4 Insert U-Disk into USB hole on the left shoulder massage device, to play music and enjoy massage.
- 5 Enjoy the massage by using the remote control.

▲ Make sure the switch is off before you insert the plug of cable line into the socket.

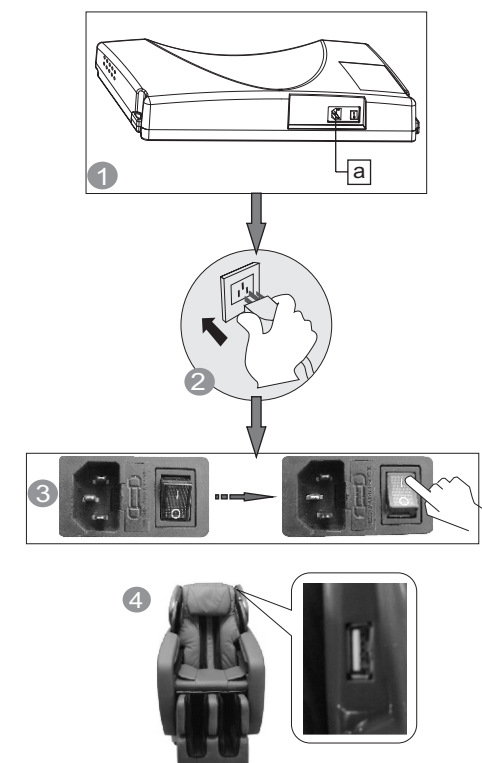



## Environment



## Caution



Keep away from any humid or wet areas.



Keep out of direct sunlight or area with a heat concentration such as heating vents and ovens.



Please be sure the chair is placed on top of a completely flat surface. If NOT the chair may have frame damage, cause the chair to short and will void warranty.

- **Check places in front**

Check that there are no children or pets within 3 feet when using this product. This may cause serious injury to surround people or pets when the chair is in motion.



- **Check power cable, plug**

Keep this chair clean at all times and remove the dust frequently.

Make sure the power cable is kept clean and that nothing is squeezing the power cable.

The cable should never be placed under the chair.



## Check environment

- **Space size for using the chair**

- At least 10cm from wall.



- At least 30cm in front of the leg.

- **Check surroundings**

When the backrest or legrest reclines or extends, please pay attention to:

- (1) Check any person or things in every direction.
- (2) Check the space size.



## How to move massage chair



## Caution

- ✦ Be sure the chair is in the upright position and unplugged when moving.

## How to move

- ✦ Remove the power cable from the chair to avoid damage to the cable or tripping. Be sure the power switch on the back bottom of the chair is in the off position.
- ✦ When laying the chair down, bring it down very softly. Any sudden impact will cause internal damage.
- ✦ Do not use the rollers on the back of the chair if you have wood floors that are soft and receptive to denting. The wheels are support a lot of weight on the small surface, creating a lot of pressure.



## Normally

- 1 Lift the legrest up as shown below. Using the rear wheels you can move the chair.

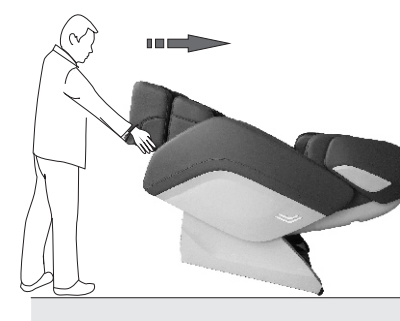

Please hold the footrest to move the chair as shown in the picture in case any scratches on the leatherette

## Adjustment before massage

- **Before adjustment**

- ✦ When starting the massage be sure to be in the desired position and then select the program. The computer body scan will initiate and map out your body for 15 sec.

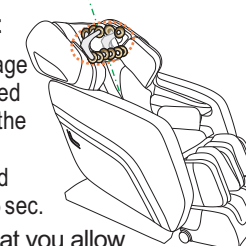

- ✦ It is recommended that you allow for the body scan to read your back before starting your massage. This will ensure the best possible massage experience. If the body scan does not get the correct reading it will automatically start at the default position which is the highest point.

**Right position:** Your back cling to the chair back, the head clings to the pillow.



The remote control gives "beep" sound after acupuncture point tracking detecting finished, when micro-adjustment is needed, just press up/down key on the remote control.

- ✦ Avoid for the massage head detecting your acupuncture point position not right, otherwise you won't get good massage.

- **Kind suggestion**



- When you feel the intensity isn't strong enough, take off the pillow or cushion.

- Because the chair is heavy, it may ruin your floor in long time setting. Please put a blanket or other soft things to protect your floor.



Manual control

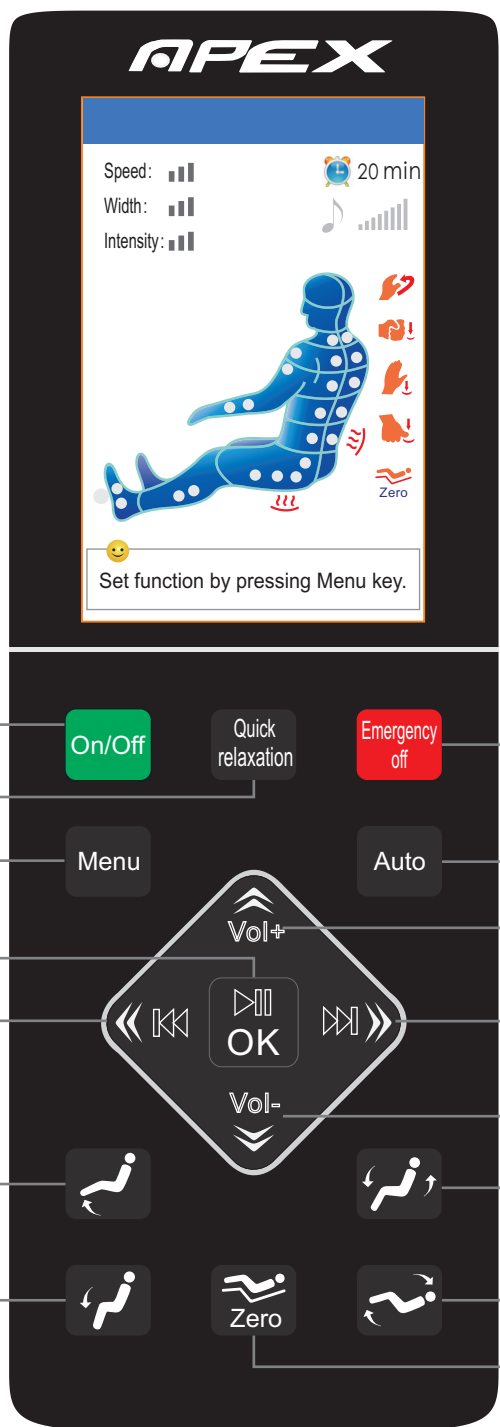

- On/Off
- Quick relaxation
- Emergency off
- Menu
- Auto
- Up Volume plus
- Down Volume minus
- legrest up
- legrest down
- Zero-Gravity
- Emergency off
- Auto
- Up Volume plus
- Right Next music
- Down Volume minus
- backrest up & Legrest down
- Legrest up & backrest down
- Zero-Gravity

Massage operation



1. The on/off button powers the chair on and off. When the chair is turned off the chair will go back to its default position.



2. This is a quick 8 minute preset program for the times when you just have minutes to enjoy a full length massage.



3. This button will immediately stop all functions of the chair.



4. The menu button will take you to the menu page on the remote to select features such as massage types, language, time, etc.



5. This is a direct link to selecting a preset program.

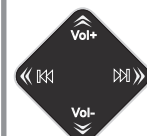

6. This button serves a multi-purpose function. It is used for volume, music selection and moving in the menu screen.



7. The center button pauses and plays the music. It is also used to confirm the selection in the menu mode.



8. Raises the legs up.



9. Raises the backrest up and the legs down at the same time.



10. This lowers the legs.



11. This raises the legs up and the backrest down at the same time.



12. This button positions the chair to the zero gravity setting.

Massage operation

LCD display graphic description

Main interface



Press "on/off" button when power is on, a buzzer beeps once short and brittle. LCD screen display boot screen, after 2-3 seconds it displays the main interface and enter standby mode. Main interface show massage position, method, time, music, heating current massage status etc., all information will be updated timely when the chair start working.

- Message function
- Kneading
  - Tapping
  - Knocking
  - Pressing
  - Zero gravity
  - Massage time left

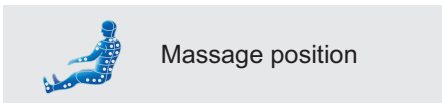

- ||| Massage speed (slow, mid, fast)
- ||| Massage width (narrow, mid, wide)
- ||| Air intensity ( weak, mid, strong)

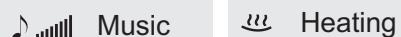

Menu interface



Press the "menu" button in the main interface, it will switch to the menu interface, user can set all massage function. Press the "menu" button in the menu interface will exit and return to the main menu interface.

**Auto massage:** After press "menu" button the cursor stop on auto massage program menu item by default, press the "OK" button, there are five optional auto massage methods, also contain five special auto massage modes.

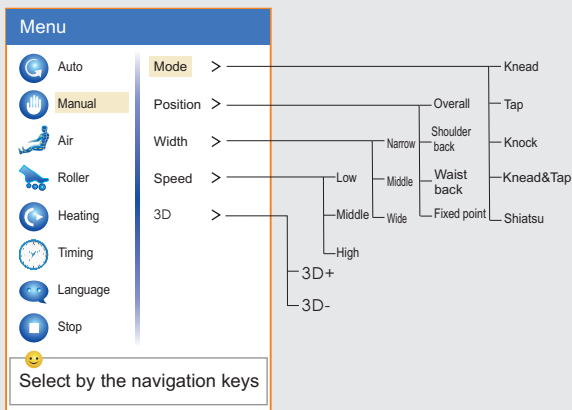

**Manual massage:** press "menu" key, select manual massage by the navigation key, press the "OK" button, there are five options : mode, position, width adjustment, speed adjustment, 3D function adjustment. Choose the corresponding function, then press the "OK" button to enter next menu, select the required massage method, position, width and speed, 3D function adjustment.

When massage chair in manual fixed point work modes, users can use up/down button to adjust massage position, information for "massage position adjusting..." will be show at the bottom of the display screen.

LCD display graphic description

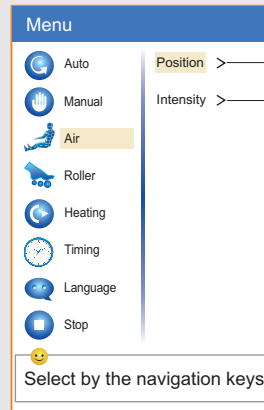

**Air :** After press MENU button,choose "air pressure" through navigation key, Press "OK" button , there are two kinds of air pressure related function: Position and Intensity; Choose the corresponding function, then press "OK" to enter next menu and choose required function.

**Roller :** press"menu"button, select foot roller massage by the navigation key, press the "OK" button, Press "OK" button, choose rolling massage mode.

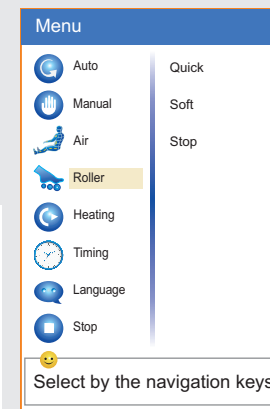

**Waist and bottom heating:** In menu mode, choose waist and bottom heating by navigation key, to start or stop it.

**Timing:** press "menu" key, through the navigation key to select menu item timing , can choose massage time : 30 minutes, 20 minutes, 10minutes, the default time is 20 minutes, the chair will turn off automatically after time is up.

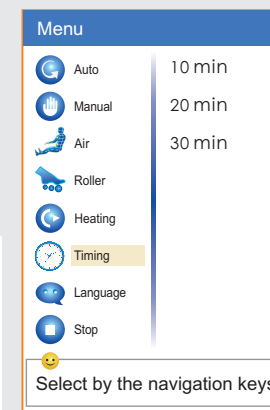

**Language:** press "menu" key, select language through the navigation key, then select the needed language.

**Stop:** press "menu" key, select stop through the navigation key, it will stop massage, and back to main interface.



After Power is on, the first time to use auto program, massage chair will start acupuncture point detecting, and "acupuncture point tracking ..." will be shown on screen display. After acupuncture point tracking detecting is finished, buzzer will tick 5 times (once every second), meanwhile, the massage machine is located in shoulders position, if user think the position is not proper, press Up and Down to adjust, when adjusting, "acupuncture point adjusting..." is showing on screen display. Default working time is 20 minutes. ( Massage chair will turn off and return after the massage is over)

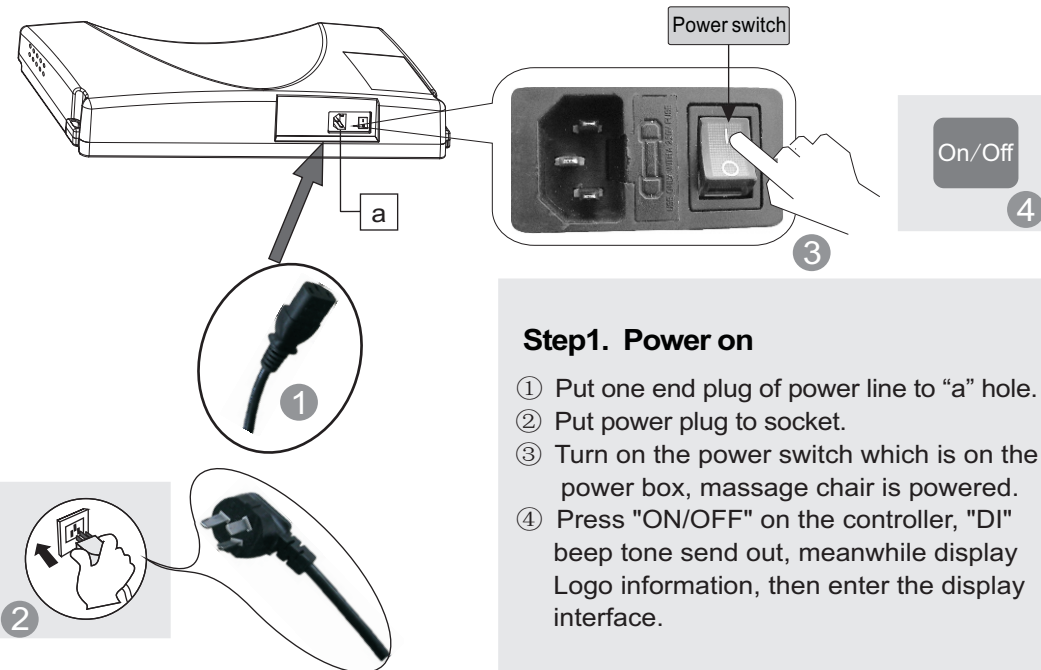

## ON/OFF

**Step1. Power on**

- ① Put one end plug of power line to "a" hole.
- ② Put power plug to socket.
- ③ Turn on the power switch which is on the power box, massage chair is powered.
- ④ Press "ON/OFF" on the controller, "DI" beep tone send out, meanwhile display Logo information, then enter the display interface.

**Step2. Massage**

- ① Operate according to controller operation instruction.
- ② When massage stop, massage machine return to the default position, meanwhile "Shutting down" displayed on the controller, controller off after 2-3 seconds.

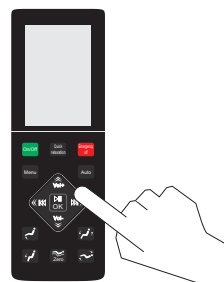
**Step3. Turn off the power**

- ① When the chair is On, press On/Off button to turn off the massage chair and it will restore automatically.
- ② Turn off the power switch on the bottom of the back of chair after the rollers stay at storage position.
- ③ Unplug the power plug from the socket.

**Warning**

1. Before using, pull up the pillow, back cushion etc. to check if the PU material is broken, if there is damage, please stop using, unplug the chair, and ask for repairment.
2. Only plug to proper socket.

**Attention**

1. Before sitting down, make sure there is no things pinched between armrest, legrest, backrest and seat of the chair.
2. Make sure the chair is in returned position before using.
3. Do not stand on it when using the massage chair.

## Function Illustration

**● Legrest Up**

Press this button on controller, legrest goes up. Release the button, legrest stops moving, the angle is locked in this position.

**● Legrest extend and retract**

Legrest can extend or retract within a range of 20CM.

**● Legrest Down**

Press this button on controller, legrest goes down. Release the button, legrest stops moving, the angle is locked in this position.

**● Arm massage**

Put arms between arm airbags before the embedded airbags filled with air. It will perform pinch massage techniques to arms and hands after airbags inflating.

**● Legrest up and backrest down**

Press this button on controller, backrest go down and legrest go up. Release this button, backrest and legrest stop moving, the angle is locked in this position.

**● Shoulder massage**

Multilayer extrusion airbags is deployed on both sides of the shoulder. Achieve pressure shoulder stretch massage, relieve shoulder fatigue.

**● Backrest up and Legrest down**

Press this button on controller, backrest go up and legrest go down. Release this button, backrest and legrest stop moving, the angle is locked in this position.

**● Foot roller massage**

Footrest parts with roller massage and air pressure massage function. Through stimulating the foot reflex zones, and clear the body meridians, regulate and restore human organs function, improve the body resistance and immunity effectively.

**● Zero gravity**

Press the button "Zero", backrest go down and legrest raise up, the chair go into Zero gravity status automatically. Press the Button again, the backrest and legrest stop moving, and it will lock at this position. However to change the angles, we can keep comfortable massage status all the time.

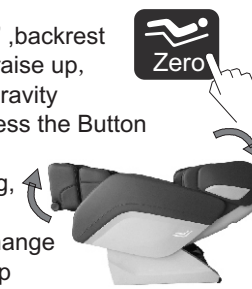

1. Please make sure there is no people, no pets or any stuff within range for backrest to avoid unexpected hurt or property loss.
2. When adjusting the backrest, be careful the gap between the backrest and armrest.
3. When the legrest is moving, please do not stand on or leave from the seat, do not stop the legrest from moving in case of causing damage to the chair.
4. Please refer to control instruction for more details.

## Restoration of massage chair

- 1 Make sure there is no people or pet or anything within the range of backrest and legrest.



- 2 Make backrest and legrest restore to the normal position by controller. (or press ON/Off key to make backrest and legrest restore to the normal position)



- 3 After restoring, put the controller back into the embedded arm massage position of the right armrest.



- 4 Put the back cushion and pillow pad on to the right position.

- 5 Switch off the power.

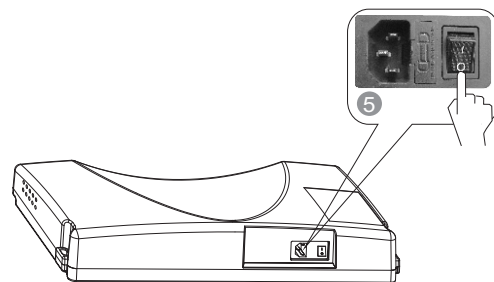

- 6 Unplug the electricity from the socket. (Attention: hold the right plug position)

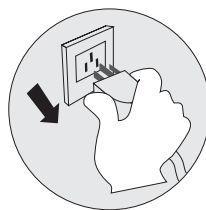

- 7 Clean the chair if necessary.



## Attention!

- After using, press ON/OFF to end all the massage method and wait for restoration. Make sure to cut the electricity to avoid any unexpected hurt to children or pets.
- After using, turn off the power, unplug the electricity. Avoid moisture, dirt and aging of insulation in case of causing damage.

## Synthetic leather

## ● General cleaning

Clean with tidy, soft and dry cloth slightly.



(Chemical or medical cleaning products are forbidden)



## ● If leather is dirty

- Dip soft cloth into 3-5% neutral detergent solution, squeeze it then clean the stain on the surface gently.
- Wash cloth, squeeze it and wipe with detergent.

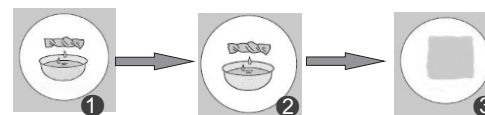

- Clean it softly with dry cloth.
- Allow to dry (air blower is prohibited)

## Cloth material

- Dip cloth into weak neutral detergent, squeeze it and clean the material surface.

- (Diluent, gas, alcohol are prohibited)
- Brush the dirty parts with weak neutral detergent. (avoid excessive brushing) Excessive cleaning may cause damage to cloth material.



- Wipe with water-dipped but squeezed cloth.
- Allow to dry.

## Plastic parts

- Dip cloth into neutral detergent, squeeze it and clean.
- Wipe with water-dipped but squeezed cloth.
- Allow to dry.



## Clean the controller

- Wipe with soft cloth after squeezing.
- Allow to dry. Propellant, diluent or alcohol are prohibited.



## About cleaning

- Before cleaning, unplug the electricity, don't touch plug with wet hands.
- Make sure hands are dry when plugging to the socket.
- If failed to follow the mentioned instruction, user may get electric shock or burned.

## FAQ and Troubleshooting

Trouble	Possible reason	Troubleshooting
The massage chair can't work after power is on.	Check if the control is on or not.	Open control switch
	Not choose massage function	Choose massage function
	Check whether the plug and socket in poor contact.	Make sure plug and socket are connected.
	Wire or plug has damaged.	Please ask manufacturer or appointed or authorized maintenance man for checking and replacement.
	The fuse burned out.	Replace fuse of same specification.
	Something wrong with inner circuit	Please ask appointed or authorized maintenance man for checking and repairing.
There is beep sound inside the massager while working.	It is sound of air pump, motor and mechanical parts.	Normal sound, no need to pay attention to it.
Different height of the left roller and right roller.	Massage rollers work on shifts.	Normal, no need to pay attention to it.
Sound suddenly becomes much louder while working.	Check if it is due to long time working.	Turn off the power to have the massager rest for over half an hour before next turn working.
	Inner parts fretted away due to long time work. It's normal	Please ask appointed or authorized maintenance man for checking and repairing.
Massage function suddenly stops while working.	Suddenly power-down	Connect the electricity power again
	Setting time is up.	Turn off the power to have the massager rest for over half an hour before next turn working.
Neither the backrest nor the legrest can be lay down.	Check if there are any obstacles; the chair overloads; for the sake of safety, sometimes the massage machine may automatically stop working.	Remove the obstacles; turn off the power to have the massager rest for over half an hour before next turn working.
The chair can't return to its original position.	Excessive operation; setting time is up.	Please ask manufacturer or appointed or authorized maintenance man for checking and replacement.
Electric wire or plug give out heat	It may work overload	Turn off the power to have the massager rest for over half an hour before next round working.
	Other abnormal case	Stop using, and ask appointed maintenance man for help.



Note: If the troubles are not caused by above reasons, please turn off the power switch and cut off the power, then contact the manufacturer or service agent to repair your chair.

## Technical data

Name	Apex AP-Pro Regal	Power	240W
Model	Apex AP-Pro Regal	NW/GW	Main body : 181/210LBS Armrest : 37/54LBS
Input voltage	<input type="checkbox"/> AC120V, 60Hz <input type="checkbox"/> AC220V, 50/60Hz <input type="checkbox"/> AC240V, 50Hz	Packing size	Main body: 55×30×34IN Armrest : 45×17×31IN (L×W×H)
Safety design	Class I		